



PIPER PRESS

HENLEY-ON-THAMES EDITION



2022



THE PIPER TEAM WARMLY WELCOMES YOU TO THE HENLEY-ON-THAMES 2022 EVENT

We are delighted to be back in Henley for our 10th annual boat exhibition. The event is all about welcoming new members to the Piper Boats Family and to have a reunion with friends from past & present.

Boats that we have built so far this year have been two 12C cruisers, one 49 Motor, two 55 Luxemotor, two 57 Nivernais and one 60 Motor so we've been keeping busy!

Some of these boats remain on the Thames and have been enjoying the 2022 season here and you will see some of them today.

If there is one thing that hasn't happened throughout these difficult few years, it's a dampening of our spirits to build perfect boats for passionate customers who have the dream of building their own unique boat.

Piper Boats excel at bringing your ideas to life, producing boats with a modern living space within a classic Dutch style barge design.

This event is the chance for all our prospective owners to see what Piper Boats can do and what options you have when buying a Piper barge. We encourage you to ask any and every question you can, of us and of the owners. You can find out what is really like to build

a boat with the Piper Team and get all those bits of advice you might not have known you ever needed!

We'd also like to extend a warm message of appreciation to all the Piper boat owners who have taken time this weekend to bring their boats along and be part of this event. It's a source of great pride for us that you all share our passion and that you enjoy this weekend as much as us! Thank you for being here with us, being part of the Piper Boats community, and for displaying your beautiful boats.

One of the biggest outcomes from 2020 and 2021 was that it saw the launch of our new river cruiser – the 12C. We are incredibly proud of our new style of boat and believe it offers something different to what's currently available. Piper Boats have a lot to offer to the river cruiser market – bringing our ideas and styling across from our experience with Dutch style barge building. Our cruiser and our varying range of Dutch barge style boats mean that we really do have something for everyone!

We would love to discuss more about your ideas and reflections, so don't be shy – have a look, ask questions, and enjoy the weekend.



We have a fantastic selection of barges this year with eighteen taking part.
Here is the 2022 line-up of the boats on display!



MERLOT - 49M

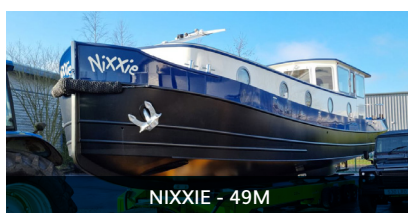

NIXXIE - 49M



NEMO X - 49M



THAMES DIPPER - 49M



JABBERWOCK - 49M



JANGUS - 55L



CONSTANCE - 55L



JACOBS CREEK - 55L



INFINITY - 55L



EAWYNN - 55L



IN A MINUTE - 57N



STEEL AWAY - 57N



AXIOM - 60M



EMILY-ANNE - 60M



EMILY XX - 60M



KRACKEN - 60M



PROVIDENCE - 60N



EADLIN - 65M



You can always
recognise a Piper boat.

Designed expertly.

Made exceptionally.

49M

MOTOR CLASS DUTCH BARGE

OVERALL LENGTH: 49FT / 14.95M
OVERALL BEAM: 13FT 10IN / 4.23M
AIR DRAFT: 2.95M
DRY WEIGHT: 29 TONNE

GUIDE COST PRICE

£335,000*

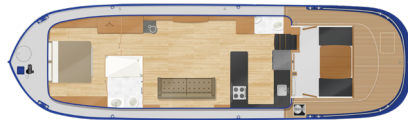

SPECIFICATION

HULL

Shipbuilding Quality Grade A steel plate according to EN10204 / 3.2 LRS
Shipbuilding plate blasted to SA 2.5 and primed by Dutch supplier
Spray foam insulation
13mm keel plate
8mm chines & hull sides
6mm decks
5mm superstructure
1750L water tank with level indicator
1240L main propulsion fuel tank with level indicator
230L gravity auxiliary fuel tank with level indicator (if refleks stove installed)
875L black waste tank with level indicator
16L grey waste buffer tank with pump (divertible to black tank)

EXTERIOR

Stainless steel hand rails and bollards
Jotun approved external marine paint system (choice of colours, specification available on request)
Double glazed & thermally broke windows to wheelhouse
Double glazed & thermally broke portholes to cabin
Automated hardwood mast with powder coated stainless steel tabernacle
Hardwood double glazed dog box with cover
Front barge fender
Navigation lights (port, starboard, stern, anchor, steaming) & headlight
Basic mooring lines 14mm thick x 15m long

ENGINE, GENERATOR & HEATING

Beta 105hp engine with PRM 280 gearbox keel cooled
Kabola pressure jet central heating boiler
50L calorifier
1kw immersion heater
Heating via radiators
5kVA soundproof enclosed marine generator
ROLLS AGM 2-volt cells in excess of 1150 a/hr (c20 rate)

VETUS AGM batteries for thrusters & engine start
3kw Mastervolt inverter/charger
3.5kw Mastervolt isolation transformer
Mastervolt battery monitoring system
Twin alternators 12v
125kgf electric bow thruster
95kgf electric stern thruster
Electric anchor winch

WHEELHOUSE

Fixed steel wheelhouse
Lined with sapele
Removable table with drop down leaf converts into a double bed
Seating for 4 people
Access to engine room via the steps under the seating

DASH

Simrad 7" chart plotter with basic mapping
Simrad VHF Radio DSC
RPI (Rudder Position Indicator) + Depth Gauge
Engine panel & controls
Thruster controls
Hydraulic steering with bypass

GALLEY

Fitted with premium oak plywood
Shaker style hardwood oak doors
Composite work tops with waterfall edges
Stainless steel inset sink
Gas hob and oven with an extractor hood
Built in microwave
Vitrifrigo marine fridge freezer 12v
Slimline Dishwasher (Customer to supply)
Washer/dryer (Customer to supply)
Engineered wooden flooring
Central heating radiator

SALOON

Under floor storage/cellar
Engineered wooden flooring
TV & Audio (Customer to supply)

Refleks 2000KT diesel stove (stove included in one bedroom layout only)
Large central heating radiator

MASTER BEDROOM

King size bed
Cupboards and drawers to port and starboard
Full height wardrobe
Marine Aircor
TV point
Central heating radiator
Engineered wooden flooring or carpet (customer choice)

SECOND BEDROOM

Second bedroom applicable to certain layouts only
Sliding privacy hatch into saloon
Dinette table and seating which converts to a double bed
Overhead storage and small wardrobe
Engineered wooden flooring or carpet (customer choice)

ENSUITE TO MASTER BEDROOM

Walk in shower with glass screen
Thermostatic shower valve
Marine remote flush toilet
Heated towel radiator
Vanity unit with integrated basin & waterfall edging

DAY LOO

Day loo applicable to certain layouts only
Marine remote flush toilet
Heated towel radiator
Washbasin

Optional one bedroom layout

Optional collapsible hardwood wheelhouse

*Price is subject to the year in which the barge is to be constructed and based on Piper's annual price list.

** Piper Boats reserve the right to alter the specification as required (E&OE).

*** Price quoted is excluding VAT.

LUXEMOTOR CLASS DUTCH BARGE

49L



OVERALL LENGTH: 49FT / 14.9M
OVERALL BEAM: 13FT 10IN / 4.23M
AIR DRAFT: 2.925M
DRY WEIGHT: 31 TONNE

GUIDE COST PRICE

£390,000*



SPECIFICATION

HULL

Shipbuilding Quality Grade A steel plate according to EN10204 / 3.2 LRS
Shipbuilding plate blasted to SA 2.5 and primed by Dutch supplier
Spray foam insulation
13mm keel plate
8mm chines & hull sides
6mm decks
5mm superstructure
1750L water tank with level indicator
1110L main propulsion fuel tank with level indicator
230L gravity auxiliary fuel tank with level indicator (if reflex stove installed)
680L black waste tank with level indicator
16L grey waste buffer tank with pump (divertible to black tank)

EXTERIOR

Stainless steel hand rails and bollards
Jotun approved external marine paint system (choice of colours, specification available on request)
Double glazed & thermally broke windows to wheelhouse
Double glazed & thermally broke portholes to cabin
Automated hardwood mast with powder coated stainless steel tabernacle
Hardwood double glazed dog box with cover
Front barge fender
Navigation lights (port, starboard, stern, anchor, steaming) & headlight
Basic mooring lines 14mm thick x 15m long
Secondary helm position

ENGINE, GENERATOR & HEATING

Beta 105hp engine with PRM 280 gearbox keel cooled
Kabola pressure jet central heating boiler
65L calorifier
1kw immersion heater
Heating via radiators
5kVA soundproof enclosed marine generator
ROLLS AGM 2-volt cells in excess of 1150 a/hr (c20 rate)
VETUS AGM batteries for thrusters & engine start
3kw Mastervolt inverter/charger
3.5kw Mastervolt isolation transformer
Mastervolt battery monitoring system
Twin alternators 12v

160kgf hydraulic bow thruster
95kgf hydraulic stern thruster
Hydraulic anchor winch

WHEELHOUSE

Fixed steel wheelhouse
Lined with sapele
Removable table with drop down leaf converts into a double bed
Seating for 4 people
Access to engine room via passageway under wheelhouse

UPPER HELM

Hydraulic power steering
RPI (Rudder Position Indicator) + Depth Gauge
Engine panel & controls
Thruster controls
Simrad 7" chart plotter with basic mapping

DASH

Simrad 7" chart plotter with basic mapping
Simrad VHF Radio DSC
RPI (Rudder Position Indicator) + Depth Gauge
Engine panel & controls
Thruster controls
Hydraulic power steering

GALLEY

Fitted with premium oak plywood
Shaker style hardwood oak doors
Composite work tops with waterfall edges
Stainless steel inset sink
Gas hob and oven with an extractor hood
Built in microwave
Vitrifrigo marine fridge freezer 12v
Slimline Dishwasher (Customer to supply)
Washer/dryer (Customer to supply)
Engineered wooden flooring
Central heating plinth heater

SALOON

Under floor storage/cellar
Engineered wooden flooring
TV & Audio (Customer to supply)
Refleks 2000KT diesel stove (stove included in one bedroom layout only)
Large central heating radiator

MASTER BEDROOM

King size bed
Cupboards and drawers to port and starboard
Full height wardrobe
Marine Aircon
TV point
Central heating radiator
Engineered wooden flooring or carpet (customer choice)

SECOND BEDROOM

Second bedroom applicable to certain layouts only
King size bed
Full height wardrobe
Cupboards and drawers to port and starboard
Marine Aircon
TV point
Central heating radiator
Engineered wooden flooring or carpet (customer choice)

ENSUITE TO MASTER BEDROOM

760 x 760 shower enclosure
Thermostatic shower valve
Marine remote flush toilet
Heated towel radiator
Vanity unit with integrated basin & waterfall edging edging

ENSUITE TO SECOND BEDROOM

Walk in shower with glass screen
Thermostatic shower valve
Marine remote flush toilet
Heated towel radiator
Vanity unit with integrated basin & waterfall edging

DAY LOO

Day loo applicable to certain layouts only
Marine remote flush toilet
Heated towel radiator
Washbasin

Optional one bedroom layout

*Price is subject to the year in which the barge is to be constructed and based on Piper's annual price list.

** Piper Boats reserve the right to alter the specification as required (E&OE).

*** Price quoted is excluding VAT.

55L

LUXEMOTOR CLASS DUTCH BARGE

OVERALL LENGTH: 55FT 9IN / 17M
OVERALL BEAM: 13FT 11IN / 4.24M
AIR DRAFT: 2.925M
DRY WEIGHT: 33 TONNE

GUIDE COST PRICE

£430,000*

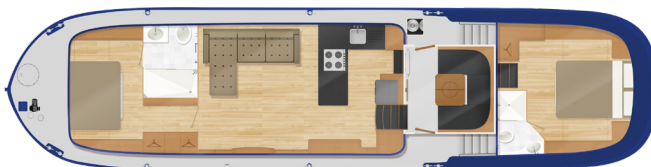
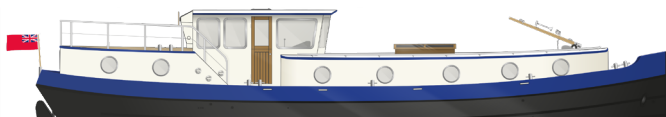

SPECIFICATION

HULL

Shipbuilding Quality Grade A steel plate according to EN10204 / 3.2 LRS
Shipbuilding plate blasted to SA 2.5 and primed by Dutch supplier
Spray foam insulation
13mm keel plate
8mm chines & hull sides
6mm decks
5mm superstructure
1750L water tank with level indicator
1170L main propulsion fuel tank with level indicator
230L gravity auxiliary fuel tank with level indicator (if reflex stove installed)
875L black waste tank with level indicator
16L grey waste buffer tank with pump (divertible to black tank)

EXTERIOR

Stainless steel hand rails and bollards
Jotun approved external marine paint system (choice of colours, specification available on request)
Double glazed & thermally broke windows to wheelhouse
Double glazed & thermally broke windows & portholes to cabin
Automated hardwood mast with powder coated stainless steel tabernacle
Hardwood double glazed dog box with cover
Front barge fender
Navigation lights (port, starboard, stern, anchor, steaming) & headlight
Basic mooring lines 14mm thick x 15m long
Secondary helm position

ENGINE, GENERATOR & HEATING

Beta 115hp engine with PRM 280 gearbox keel cooled
Kabola pressure jet central heating boiler
75L calorifier
1kw immersion heater
Heating via radiators
5kVA soundproof enclosed marine generator
ROLLS AGM 2-volt cells in excess of 1150 a/hr (c20 rate)
VETUS AGM batteries for thrusters & engine start
3kw Mastervolt inverter/charger
3.5kw Mastervolt isolation transformer
Mastervolt battery monitoring system

Twin alternators 12v
160kgf hydraulic bow thruster
95kgf hydraulic stern thruster
Hydraulic anchor winch

WHEELHOUSE

Fixed steel wheelhouse
Lined with sapele
Removable table with drop down leaf converts into a double bed
Seating for 4 people
Access to engine room via passageway under wheelhouse

UPPER HELM

Hydraulic power steering
RPI (Rudder Position Indicator) + Depth Gauge
Engine panel & controls
Thruster controls
Simrad 7" chart plotter with basic mapping

DASH

Simrad 7" chart plotter with basic mapping
Simrad VHF Radio DSC
RPI (Rudder Position Indicator) + Depth Gauge
Engine panel & controls
Thruster controls
Hydraulic power steering

GALLEY

Fitted with premium oak plywood
Shaker style hardwood oak doors
Composite work tops with waterfall edges
Stainless steel inset sink
Gas hob and oven with an extractor hood
Built in microwave
Vitrifrigo marine fridge freezer 12v
Slimline Dishwasher (Customer to supply)
Washer/dryer (Customer to supply)
Engineered wooden flooring
Central heating plinth heater

SALOON

Under floor storage/cellar
Engineered wooden flooring
Refleks 2000KT diesel stove
TV & Audio (Customer to supply)
Large central heating radiator

MASTER BEDROOM

Super king size bed
Cupboards and drawers to port and starboard
Full height wardrobe
Marine Aircon
TV point
Central heating radiator
Engineered wooden flooring or carpet (customer choice)

SECOND BEDROOM

King size bed
Full height wardrobe
Cupboards and drawers to port and starboard
Marine Aircon
TV point
Central heating radiator
Engineered wooden flooring or carpet (customer choice)

ENSUITE TO MASTER BEDROOM

760 x 760 shower enclosure
Thermostatic shower valve
Marine remote flush toilet
Heated towel radiator
Vanity unit with integrated basin & waterfall edging

ENSUITE TO SECOND BEDROOM

Walk in shower with glass screen
Thermostatic shower valve
Marine remote flush toilet
Heated towel radiator
Vanity unit with integrated basin & waterfall edging

DAY LOO

Day loo applicable to certain layouts only
Marine remote flush toilet
Heated towel radiator
Washbasin

Optional one-bedroom layout

*Price is subject to the year in which the barge is to be constructed and based on Piper's annual price list.

** Piper Boats reserve the right to alter the specification as required (E&OE).

*** Price quoted is excluding VAT.

NIVERNAIS CLASS DUTCH BARGE

55N



OVERALL LENGTH: 55FT 2IN / 16.85M

OVERALL BEAM: 12FT 6IN / 3.81M

AIR DRAFT: 2.875M

WHEELHOUSE DOWN: 2M*

DRY WEIGHT: 30 TONNE

GUIDE COST PRICE

£325,000**



SPECIFICATION

HULL

Shipbuilding Quality Grade A steel plate according to EN10204 / 3.2 LRS
Shipbuilding plate blasted to SA 2.5 and primed by Dutch supplier
Spray foam insulation
13mm keel plate
8mm chines & hull sides
6mm decks
5mm superstructure
1260L water tank with level indicator
1015L main propulsion fuel tank with level indicator
750L auxiliary fuel tank with level indicator
1020L black waste tank with level indicator
16L grey waste buffer tank with pump (divertible to black tank)

EXTERIOR

Stainless steel hand rails and bollards
Jotun approved external marine paint system (choice of colours, specification available on request)
Double glazed & thermally broke windows to wheelhouse
Double glazed & thermally broke windows & portholes to cabin
Automated hardwood mast with powder coated stainless steel tabernacle
Hardwood double glazed dog box with cover
Front barge fender
Navigation lights (port, starboard, stern, anchor, steaming) & headlight
Basic mooring lines 14mm thick x 15m long

ENGINE & HEATING

Beta 90hp engine with PRM 280 gearbox keel cooled Kabola pressure jet central heating boiler
75L calorifier
1kw immersion heater
Heating via radiators
ROLLS AGM 2-volt cells in excess of 1150 a/hr (c20 rate)
VETUS AGM batteries for thrusters & engine start
3kw Mastervolt inverter/charger

3.5kw Mastervolt isolation transformer
Mastervolt battery monitoring system
Twin alternators 12v
125kgf electric bow thruster
95kgf electric stern thruster
Electric anchor winch

WHEELHOUSE

Fixed steel wheelhouse
Lined with sapele
Removable table with drop down leaf converts into a double bed
Seating for 4 people
Access to engine room via the steps under the seating

DASH

Simrad 7" chart plotter with basic mapping
Simrad VHF Radio DSC
RPI (Rudder Position Indicator) + Depth Gauge
Engine panel & controls
Thruster controls
Hydraulic steering with bypass

GALLEY

Fitted with premium oak plywood
Shaker style hardwood oak doors
Composite work tops with waterfall edges
Stainless steel inset sink
Gas hob and oven with an extractor hood
Built in microwave
Vitrifigo marine fridge freezer 12v
Slimline Dishwasher (Customer to supply)
Washer/dryer (Customer to supply)
Engineered wooden flooring
Central heating radiator

SALOON

Under floor storage/cellar
Engineered wooden flooring
TV & Audio (Customer to supply)
Large central heating radiator

MASTER BEDROOM

King size bed
Cupboards and drawers to port and starboard
Full height wardrobe
TV point
Central heating radiator
Engineered wooden flooring or carpet (customer choice)

SECOND BEDROOM

Sliding privacy hatch into saloon
Dinette table and seating which converts to a double bed
Overhead storage and small wardrobe
Engineered wooden flooring or carpet (customer choice)

MAIN BATHROOM

800 x 800 shower enclosure
Thermostatic shower valve
Marine remote flush toilet
Vanity unit with integrated basin
Heated towel radiator

** Optional collapsible hardwood wheelhouse
Refleks 2000KT diesel stove available at extra cost
5kW soundproof enclosed marine generator available at extra cost
Marine aircon unit to bedroom available at extra cost*

*Price is subject to the year in which the barge is to be constructed and based on Piper's annual price list.
** Piper Boats reserve the right to alter the specification as required (E&OE).
*** Price quoted is excluding VAT.

57N

NIVERNAIS CLASS DUTCH BARGE

OVERALL LENGTH: 57FT 2IN / 17.45M

OVERALL BEAM: 12FT 6IN / 3.81M

AIR DRAFT: 2.875M

WHEELHOUSE DOWN: 2M*

DRY WEIGHT: 31 TONNE

GUIDE COST PRICE

£350,000**



SPECIFICATION

HULL

Shipbuilding Quality Grade A steel plate according to EN10204 / 3.2 LRS
Shipbuilding plate blasted to SA 2.5 and primed by Dutch supplier
Spray foam insulation
13mm keel plate
8mm chines & hull sides
6mm decks
5mm superstructure
1750L water tank with level indicator
600L main propulsion fuel tank with level indicator
1000L auxiliary fuel tank with level indicator
1020L black waste tank with level indicator
16L grey waste buffer tank with pump (divertible to black tank)

EXTERIOR

Stainless steel hand rails and bollards
Jotun approved external marine paint system (choice of colours, specification available on request)
Double glazed & thermally broke windows to wheelhouse
Double glazed & thermally broke windows & portholes to cabin
Automated hardwood mast with powder coated stainless steel tabernacle
Hardwood double glazed dog box with cover
Front barge fender
Navigation lights (port, starboard, stern, anchor, steaming) & headlight
Basic mooring lines 14mm thick x 15m long

ENGINE, GENERATOR & HEATING

Beta 105hp engine with PRM 280 gearbox keel cooled
Kabola pressure jet central heating boiler
75L calorifier
1kw immersion heater
Heating via radiators
5kVA soundproof enclosed marine generator
ROLLS AGM 2-volt cells in excess of 1150 a/hr (c20 rate)
VETUS AGM batteries for thrusters & engine start

3kw Mastervolt inverter/charger
3.5kw Mastervolt isolation transformer
Mastervolt battery monitoring system
Twin alternators 12v
125kgf electric bow thruster
95kgf electric stern thruster
Electric anchor winch

WHEELHOUSE

Fixed steel wheelhouse
Lined with sapele
Removable table with drop down leaf converts into a double bed
Seating for 4 people
Access to engine room via the steps under the seating

DASH

Simrad 7" chart plotter with basic mapping
Simrad VHF Radio DSC
RPI (Rudder Position Indicator) + Depth Gauge
Engine panel & controls
Thruster controls
Hydraulic steering with bypass

GALLEY

Fitted with premium oak plywood
Shaker style hardwood oak doors
Composite work tops with waterfall edges
Stainless steel inset sink
Gas hob and oven with an extractor hood
Built in microwave
Vitrifrigo marine fridge freezer 12v
Slimline Dishwasher (Customer to supply)
Washer/dryer (Customer to supply)
Engineered wooden flooring
Central heating radiator

SALOON

Under floor storage/cellar
Engineered wooden flooring
Refleks 2000KT diesel stove
TV & Audio (Customer to supply)
Large central heating radiator

MASTER BEDROOM

King size bed
Cupboards and drawers to port and starboard
Full height wardrobe
Marine Aircon
TV point
Central heating radiator
Engineered wooden flooring or carpet (customer choice)

SECOND BEDROOM

Sliding privacy hatch into saloon
Dinette table and seating which converts to a double bed
Overhead storage and small wardrobe
Engineered wooden flooring or carpet (customer choice)

ENSUITE TO MASTER BEDROOM

Walk in shower with glass screen
Thermostatic shower valve
Marine remote flush toilet
Heated towel radiator
Vanity unit with integrated basin & waterfall edging

MAIN BATHROOM

800 x 800 shower tray wetroom
Thermostatic shower valve
Marine remote flush toilet
Vanity unit with integrated basin
Heated towel radiator

*Optional collapsible hardwood wheelhouse

*Price is subject to the year in which the barge is to be constructed and based on Piper's annual price list.

** Piper Boats reserve the right to alter the specification as required (E&OE).

*** Price quoted is excluding VAT.

MOTOR CLASS DUTCH BARGE

60M



OVERALL LENGTH: 60FT / 18.3M
 OVERALL BEAM: 13FT 10IN / 4.23M
 AIR DRAFT: 2.975M
 WHEELHOUSE DOWN: 2M*
 DRY WEIGHT: 35 TONNE

GUIDE COST PRICE

£380,000**

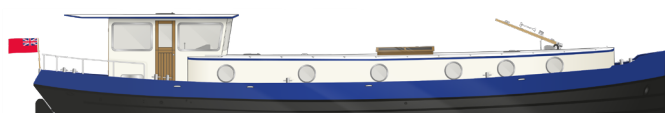

SPECIFICATION

HULL

Shipbuilding Quality Grade A steel plate according to EN10204 / 3.2 LRS
 Shipbuilding plate blasted to SA 2.5 and primed by Dutch supplier
 Spray foam insulation
 13mm keel plate
 8mm chines & hull sides
 6mm decks
 5mm superstructure
 1870L water tank with level indicator
 800L main propulsion fuel tank with level indicator
 1000L auxiliary fuel tank with level indicator
 805L black waste tank with level indicator
 16L grey waste buffer tank with pump (divertible to black tank)

EXTERIOR

Stainless steel hand rails and bollards
 Jotun approved external marine paint system (choice of colours, specification available on request)
 Double glazed & thermally broke windows to wheelhouse
 Double glazed & thermally broke portholes to cabin
 Automated hardwood mast with powder coated stainless steel tabernacle
 Hardwood double glazed dog box with cover
 Front barge fender
 Navigation lights (port, starboard, stern, anchor, steaming) & headlight
 Basic mooring lines 14mm thick x 15m long

ENGINE, GENERATOR & HEATING

Beta 115hp engine with PRM 280 gearbox keel cooled
 Kabola pressure jet central heating boiler
 75L calorifier
 1kw immersion heater
 Heating via radiators
 5kVA soundproof enclosed marine generator
 ROLLIS AGM 2-volt cells in excess of 1150 a/hr (c20 rate)
 VETUS AGM batteries for thrusters & engine start

3kw Mastervolt inverter/charger
 3.5kw Mastervolt isolation transformer
 Mastervolt battery monitoring system
 Twin alternators 12v
 160kgf electric bow thruster
 95kgf electric stern thruster
 Electric anchor winch

WHEELHOUSE

Fixed steel wheelhouse
 Lined with sapele
 Removable table with drop down leaf converts into a double bed
 Seating for 4 people
 Access to engine room via the steps under the seating

DASH

Simrad 7" chart plotter with basic mapping
 Simrad VHF Radio DSC
 RPI (Rudder Position Indicator) + Depth Gauge
 Engine panel & controls
 Thruster controls
 Hydraulic steering with bypass

GALLEY

Fitted with premium oak plywood
 Shaker style hardwood oak doors
 Composite work tops with waterfall edges
 Stainless steel inset sink
 Gas hob and oven with an extractor hood
 Built in microwave
 Vitrifrigo marine fridge freezer 12v
 Slimline Dishwasher (Customer to supply)
 Washer/dryer (Customer to supply)
 Engineered wooden flooring
 Under floor storage/cellar
 Central heating radiator

SALOON

Under floor storage/cellar
 Engineered wooden flooring
 Refleks 2000KT diesel stove

TV & Audio (Customer to supply)
 Large central heating radiator

MASTER BEDROOM

King size bed
 Cupboards and drawers to port and starboard
 Full height wardrobe
 Marine Aircon
 TV point
 Central heating radiator
 Engineered wooden flooring or carpet (customer choice)

SECOND BEDROOM

Twin single beds with drawer storage underneath
 Overhead storage and small wardrobe
 Central heating radiator
 Engineered wooden flooring or carpet (customer choice)

ENSUITE TO MASTER BEDROOM

Walk in shower with glass screen
 Thermostatic shower valve
 Marine remote flush toilet
 Heated towel radiator
 Vanity unit with integrated basin & waterfall edging

DAY LOO

Marine remote flush toilet
 Heated towel radiator
 Washbasin
 Compact 600 x 600 shower enclosure with curtain

Optional one bedroom layout

*Optional collapsible hardwood wheelhouse

*Price is subject to the year in which the barge is to be constructed and based on Piper's annual price list.

** Piper Boats reserve the right to alter the specification as required (E&OE).

*** Price quoted is excluding VAT.

65M

MOTOR CLASS DUTCH BARGE

OVERALL LENGTH: 60FT / 18.3M
OVERALL BEAM: 13FT 10IN / 4.23M
AIR DRAFT: 2.975M
WHEELHOUSE DOWN: 2M*
DRY WEIGHT: 35 TONNE

GUIDE COST PRICE

£430,000**

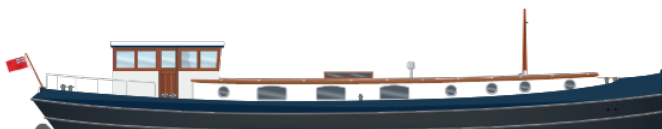

SPECIFICATION

HULL

Shipbuilding Quality Grade A steel plate according to EN10204 / 3.2 LRS
Shipbuilding plate blasted to SA 2.5 and primed by Dutch supplier
Spray foam insulation
13mm keel plate
8mm chines & hull sides
6mm decks
5mm superstructure
1870L water tank with level indicator
800L main propulsion fuel tank with level indicator
1000L auxiliary fuel tank with level indicator
805L black waste tank with level indicator
16L grey waste buffer tank with pump (divertible to black tank)

EXTERIOR

Stainless steel hand rails and bollards
Jotun approved external marine paint system (choice of colours, specification available on request)
Double glazed & thermally broke windows to wheelhouse
Double glazed & thermally broke portholes to cabin
Automated hardwood mast with powder coated stainless steel tabernacle
Hardwood double glazed dog box with cover
Front barge fender
Navigation lights (port, starboard, stern, anchor, steaming) & headlight
Basic mooring lines 14mm thick x 15m long

ENGINE, GENERATOR & HEATING

Beta 115hp engine with PRM 280 gearbox keel cooled
Kabola pressure jet central heating boiler
75L calorifier
1kw immersion heater
Heating via radiators
5kVA soundproof enclosed marine generator
ROLLS AGM 2-volt cells in excess of 1150 a/hr (c20 rate)
VETUS AGM batteries for thrusters & engine start

3kw Mastervolt inverter/charger
3.5kw Mastervolt isolation transformer
Mastervolt battery monitoring system
Twin alternators 12v
160kgf electric bow thruster
95kgf electric stern thruster
Electric anchor winch

WHEELHOUSE

Fixed steel wheelhouse
Lined with sapele
Removable table with drop down leaf converts into a double bed
Seating for 4 people
Access to engine room via the steps under the seating

DASH

Simrad 7" chart plotter with basic mapping
Simrad VHF Radio DSC
RPI (Rudder Position Indicator) + Depth Gauge
Engine panel & controls
Thruster controls
Hydraulic steering with bypass

GALLEY

Fitted with premium oak plywood
Shaker style hardwood oak doors
Composite work tops with waterfall edges
Stainless steel inset sink
Gas hob and oven with an extractor hood
Built in microwave
Vitrifrigo marine fridge freezer 12v
Slimline Dishwasher (Customer to supply)
Washer/dryer (Customer to supply)
Engineered wooden flooring
Under floor storage/cellar
Central heating radiator

SALOON

Under floor storage/cellar
Engineered wooden flooring
Refleks 2000KT diesel stove

TV & Audio (Customer to supply)
Large central heating radiator

MASTER BEDROOM

King size bed
Cupboards and drawers to port and starboard
Full height wardrobe
Marine Aircon
TV point
Central heating radiator
Engineered wooden flooring or carpet (customer choice)

SECOND BEDROOM

Twin single beds with drawer storage underneath
Overhead storage and small wardrobe
Central heating radiator
Engineered wooden flooring or carpet (customer choice)

ENSUITE TO MASTER BEDROOM

Walk in shower with glass screen
Thermostatic shower valve
Marine remote flush toilet
Heated towel radiator
Vanity unit with integrated basin & waterfall edging

DAY LOO

Marine remote flush toilet
Heated towel radiator
Washbasin
Compact 600 x 600 shower enclosure with curtain

Optional one bedroom layout

*Optional collapsible hardwood wheelhouse

*Price is subject to the year in which the barge is to be constructed and based on Piper's annual price list.

** Piper Boats reserve the right to alter the specification as required (E&OE).

*** Price quoted is excluding VAT.

LUXEMOTOR CLASS DUTCH BARGE

65L



OVERALL LENGTH: 65FT 6IN / 19.8M

OVERALL BEAM: 14FT 9IN / 4.5M

AIR DRAFT: 3M

DRY WEIGHT: 35 TONNE

GUIDE COST PRICE

£550,000*

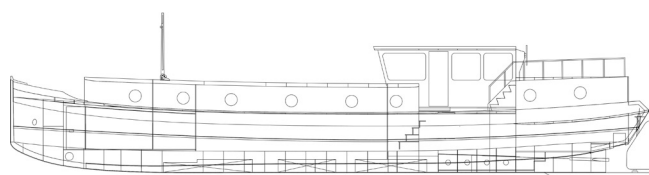
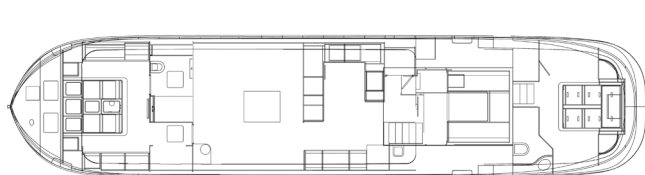

SPECIFICATION

HULL

Shipbuilding Quality Grade A steel plate according to EN10204 / 3.2 LRS
Shipbuilding plate blasted to SA 2.5 and primed by Dutch supplier
Spray foam insulation
13mm keel plate
8mm chines & hull sides
6mm decks
5mm superstructure
1870L water tank with level indicator
1240L main propulsion fuel tank with level indicator
1150L auxiliary fuel tank with level indicator
875L black waste tank with level indicator
16L grey waste buffer tank with pump (divertible to black tank)

EXTERIOR

Stainless steel hand rails and bollards
Jotun approved external marine paint system (choice of colours, specification available on request)
Double glazed & thermally broke windows to wheelhouse
Double glazed & thermally broke portholes to cabin
Automated hardwood mast with powder coated stainless steel tabernacle
Hardwood double glazed dog box with cover
Front barge fender
Navigation lights (port, starboard, stern, anchor, steaming) & headlight
Basic mooring lines 14mm thick x 15m long
Secondary helm position

ENGINE, GENERATOR & HEATING

Vetus 140hp engine with gearbox raw water cooled
Kabola pressure jet central heating boiler
75L calorifier
1kw immersion heater
Heating via radiators
7kVA soundproof enclosed marine generator
ROLLS AGM 2-volt cells in excess of 1150 a/hr (c20 rate)
VETUS AGM batteries for thrusters & engine start
3kw Mastervolt inverter/charger
3.5kw Mastervolt isolation transformer
Mastervolt battery monitoring system
Twin alternators 12v

160kgf hydraulic bow thruster
95kgf hydraulic stern thruster
Hydraulic anchor winch

WHEELHOUSE

Fixed steel wheelhouse
Lined with sapele
Removable table with drop down leaf converts into a double bed
Seating for 6 people
Access to engine room via passageway under wheelhouse

UPPER HELM

Hydraulic power steering
RPI (Rudder Position Indicator) + Depth Gauge
Engine panel & controls
Thruster controls
Simrad 7" chart plotter with basic mapping
Power steering

DASH

Simrad 7" chart plotter with basic mapping
Simrad VHF Radio DSC
RPI (Rudder Position Indicator) + Depth Gauge
Engine panel & controls
Thruster controls
Hydraulic power steering

GALLEY

Fitted with premium oak plywood
Shaker style hardwood oak doors
Composite work tops with waterfall edges
Stainless steel inset sink
Gas hob and oven with an extractor hood
Built in microwave
Vitrifrigo marine fridge freezer 12v
Slimline Dishwasher (Customer to supply)
Washer/dryer (Customer to supply)
Engineered wooden flooring
Central heating radiator

SALOON

Under floor storage/cellar
Engineered wooden flooring
Refleks 2000KT diesel stove
TV & Audio (Customer to supply)
Large central heating radiator

MASTER BEDROOM

Super king size bed
Cupboards and drawers to port and starboard
Full height wardrobe
Marine Aircon
TV point
Central heating radiator
Engineered wooden flooring or carpet (customer choice)

SECOND BEDROOM

King size bed
Full height wardrobe
Cupboards and drawers to port and starboard
Marine Aircon
TV point
Central heating radiator
Engineered wooden flooring or carpet (customer choice)

ENSUITE TO MASTER BEDROOM

760 x 760 shower enclosure
Thermostatic shower valve
Marine remote flush toilet
Heated towel radiator
Vanity unit with integrated basin & waterfall edging

ENSUITE TO SECOND BEDROOM

Walk in shower with glass screen
Thermostatic shower valve
Marine remote flush toilet
Heated towel radiator
Vanity unit with integrated basin & waterfall edging

DAY LOO

Day loo applicable to certain layouts only
Marine remote flush toilet
Heated towel radiator
Washbasin

*Price is subject to the year in which the barge is to be constructed and based on Piper's annual price list.

** Piper Boats reserve the right to alter the specification as required (E&OE).

*** Price quoted is excluding VAT.



BESPOKE INTERIOR DESIGNS

Each boat is unique,
with its own
characteristics and qualities



12C

MOTOR RIVER CRUISER

OVERALL LENGTH 11.98M

OVERALL BEAM 4.02M

AIR DRAFT 2.77M

DRAFT 0.92M

£330,000

INCLUDING VAT @ 20%

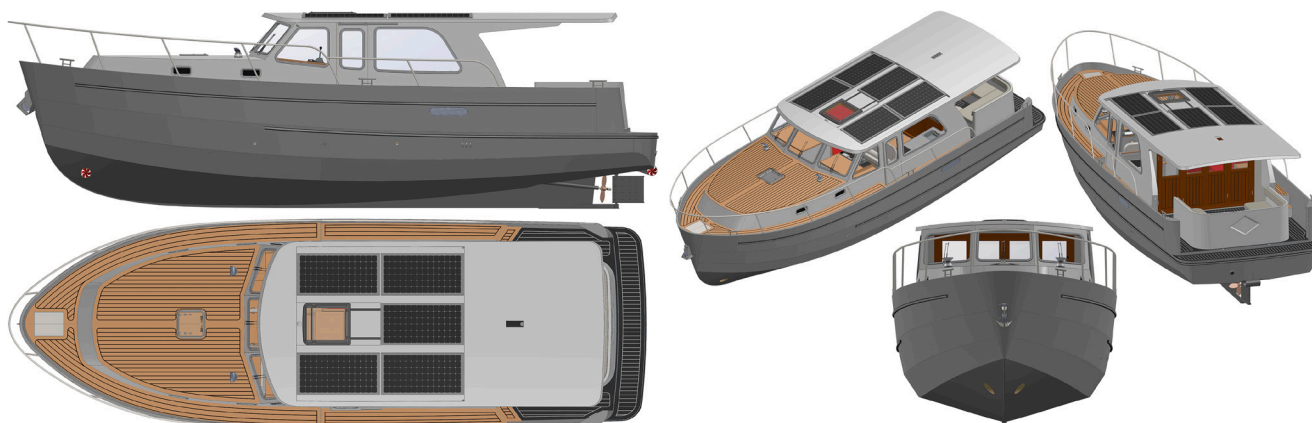

SPECIFICATION

HULL

Shipbuilding Quality Grade A steel plate according to EN10204/3.2LRS

Shipbuilding Plate Blasted to SA 2.5 and primed by Dutch supplier

13mm keel bar

6mm hull up to decks

4mm superstructure

Plank effect hull

TANKAGE

650 ltrs fresh water tank with deck fitting for filling and level gauge

650 ltrs fuel tank with twin filler point and level gauge

215 ltrs black tank with deck fitting for pump out and level gauge

INSULATION

Thermal insulation to hull and superstructure

Sonitech 45mm sound insulation to engine compartment

EXTERIOR

Stainless steel guard rails

Stainless steel mooring cleats

Jotun specified marine paint system in 2 colours with antifouling to waterline

Aluminium anodes

Marine windows

Hardwood bifold doors to stern (double glazed with integrated blinds)

Sliding door to portside by helm

Webasto electric sliding sunroof

Cowl ventilators to coachroof

Navigation lights, port, starboard, stern and anchor/mast lights

Horn

Flexiteek to all decks

U-shaped seating to stern deck

Overhead lighting to stern deck

Marine rubbing strakes

Exterior hot/cold deck shower

ENGINE & HEATING

Beta marine 85T engine with TMC 345 gearbox

Engine panel and controls

Mastervolt 130 amp 12v alternator

6 of Rolls S2-1275 AGM batteries

Victron Multiplus 12/3000/120 inverter charger

Victron Isolation transformer with 16a shorepower

Victron remote battery monitor

1200w Panasonic PV panels with Victron solar regulators

7.5 hp bow and stern thrusters

Electric anchor winch with 50m chain and 15kg anchor

Webasto hydronic heater with a combination of radiators and heater blower

65 ltr calorifier twin coil with 1kw immersion heater

SALOON

Large fixed L shape seating converts to additional guest bed

Table on pedestal that can also be used in the stern deck seating area

GALLEY

Dometic 3 burner LPG hob

Dometic 30 ltr oven with grill LPG

Vitrifrigo 130ltr stainless steel refrigerator

Vitrifrigo 65ltr wine cooler

LG composite worktops

Reginox stainless steel sink with Bristan monoblock tap

HELM

Simrad 7" chartplotter

Simrad VHF radio

Engine throttle and bow thruster controls

Twin helm seating

Door to port to ease single handed cruising

MASTER BEDROOM

Double bed

Cupboards and drawers to port and starboard

Full height wardrobe

Radiator

GUEST BEDROOM

Bunk beds

Wardrobe

Drawer unit

SHOWER ROOM

Large shower enclosure

Vanity unit

Marine toilet

Access from passageway and master bedroom

*1 Bedroom version also available, features L shaped galley fitted in replacement of the guest bedroom

** Piper Boats reserve the right to alter the specification as required (E&OE)



THE CUSTOMISATION OF YOUR DUTCH BARGE

Piper Boats believe that every boat we build has an excellent specification.

From the layout to the components used, there has been considerable thought into how the boat works and how it will be used.

There is no necessity to spend money on upgrades unless you want extra features or functionality over and above what Piper Boats believe to be necessary.

That said; Piper Boats understand that every boat owner has their own ideas and their own vision. We have the ability to provide your boat with custom configurations and components where requested.





What follows is some examples of the type of upgrades that some of our past customers have requested and received.

Layout Redesign – Custom configuration of galley units & components	£700
<ul style="list-style-type: none"> Design changes resulting from request for different positions for galley components e.g. Fridge/oven Increasing the size of the galley or changing the position/size of cupboards/drawer units 	
Layout Redesign – Changes to bathroom/cabin/saloon layout	£1,500-5,000
<ul style="list-style-type: none"> Price dependent on the quantity of bespoke design required. Bespoke requests might include: <ul style="list-style-type: none"> Repositioning of bulkheads Design of bespoke units and fixtures Inclusion of new components New layouts for ensuite/dayloo/saloon/front cabin 	
Engine upgrade (upgrade from Beta 105 to Beta 115)	£1,100
Engine upgrade (upgrade to VETUS VD.140 from Beta engine)	£7,500
18" portholes instead of 15" portholes	£600
400w Solar Panel fitout (4 x 100w semi flexible solar panels and solar regulator)	£2,000
800w Solar Panel fitout (8 x 100w semi flexible solar panels and solar regulator)	£3,500
Synthetic marine teak decking to fit the external side decks	Price available
Dependent on boat length (stern deck synthetic marine teak decking is included in the boat price)	
Hydraulic fitout (including hydraulic tank, valves, thrusters, steering, winch)	£12,000
Water filter taps in galley	£230ea
Upgrade to 7kW generator	£900
Upgrade of alternator to Mastervolt 90a alternator	£1,350
Upgrade of alternator to Mastervolt 130a alternator	£1,650
Remote control for bow/stern thruster	£400
Upgrade chartplotter from 7" screen to 9" screen	£350
Upgrade of VHF radio to include AIS receiver capability	£350
Installation of Oyster 85cm Twin LNB Auto Skew Automatic Satellite System	£3,050
Installation of autopilot navigation equipment	£2,600
Installation of another air conditioning system into rear cabin/saloon (6000 BTU)	£3,000
Installation of another air conditioning system into rear cabin/saloon (12000 BTU)	£4,000
Coppercoat antifouling (price dependent on length of boat)	£2,200 - £2,700
Black painted antifouling (price dependent on length of boat)	£1,400 - £1,700
Venetian blinds in wheelhouse (roman blinds included in front cabin)	£900
Strip paint job similar to Jacobs Creek/Thames Dipper/Axiom	£1,000
Colour painting of D-bar on cabin side and wheelhouse roof	£500
Solid handrailing around side decks of boat in stainless steel tube	£4,000

We are happy to discuss your bespoke boat, please make an appointment if there is something you would like to discuss!

THE CUSTOMER JOURNEY WITH PIPER BOATS

Piper Boats understand that commissioning a barge can be quite a daunting experience. Building a barge can be a very complex process, with different requirements & desires to be taken account of. It is the mission of Piper Boats to help guide our customers through the 'journey' from initial concept to boat launch.

We all want to have a smooth and considered build with minimum trouble; it is a matter of cooperation to make this happen.

It can be difficult to appreciate how to set out your vision for your Piper barge, the following schedule should help you understand what it is all about.

ORDERING A PIPER BOAT

You are commissioning a Piper Boat and you will have decided which model best suits your needs. All our barges are built to order, and we have an approximate waiting list of 12-18 months dependent on season. Sometimes we can make an exception if a customer has a special schedule!

You will place an order with Piper Boats and pay a deposit which will secure the slot for you.

A STANDARD BOAT

All customers buy the standard boat at order stage. This means that the boat price has a number of components & fixtures included within it which form part of a 'standard specification'.

Most customers have visited and seen our previously built boats before and have an idea of the layout, but Piper Boats will send an example drawing which gives an impression of the layout and components.



THE SPECIFICATION

The next milestone is for Piper Boats and you to agree to the final specification for the boat. Normally, you will visit our workshop and chat with us about anything which you require extra to the standard specification. There will invariably be a list of extra components and inclusions that you are interested in. When this has been quantified, we will produce a 'build specification'.

STEELWORK

The steelwork plates will be ordered, and we will start manufacture. All the steelwork required for your boat is cut out using a CNC machine. The first process is to lay the base plate and intermediate frames. Then the chines and hull can be welded in place. The decks and cabin will be installed, and it will start to look like a Dutch style barge!

Once the wheelhouse has been put in place, there is finally a lot of welding to do! It will take around 8 weeks for us to build the complete steelwork.

PAINTING

The barge will be painted throughout its journey through the workshop. The first stages will be done after steelwork is complete. The external surfaces will be shot blasted and primed, ready for our paint system. The internal steelwork will be painted before any first fix plumbing, wiring and woodwork is started.

During the internal fitout, the paint will be applied to the exterior of the boat in black and a colour of the customer's choice. A paint specification is available on request.

FITOUT

You will have a chance to review the internal design of the barge with the design team prior to any manufacturing work being started. The design will encompass any of the individual ideas that you have, and any components which make your barge bespoke in nature. Once the design is complete, all the wooden panels are CNC manufactured in our workshop, which makes the manufacturing very precise.

The plumbing and wiring are completed as part of the 'first fix' fitout. Before we start assembling all the bulkheads, the boat is insulated with spray foam. Over the course of approximately 8 weeks, the boat will be fitted to your specification and layout. The engineering will be completed during this time and all components will be commissioned and made ready for launch.

OVERNIGHT STAY AND ACCEPTANCE

Once the boat has been completed, you will be invited to come and review the boat before it is launched. This will normally involve an overnight stay at our workshop and give you a chance to check all of the work that has been completed and also have a chance to learn about some of the systems and components which have been installed on your boat.

LAUNCH

Approximately a week after your overnight stay, Piper Boats will arrange transport and craneage to launch your boat in the water. Typically, this will be a Thames & Kennet Marina but it has been known for some customers to launch their boat directly into France or Belgium! The boat will go through some launch trials and be commissioned before being handed over to its new owners!



Now the dream is finally made real, your boat is ready for use and you are free to cruise the waterways!

PAYING FOR YOUR BOAT

Payments for your boat are staged throughout the build in approximately the following way:

EXAMPLE PRICE:	£390,000
Deposit:	£5,000
Start of steelwork:	£57,000
Completion of steelwork:	£67,000
Completion of line out & installation of bulkheads:	£67,000
Substantial completion of fit out:	£77,000
Completion of build prior to delivery:	£112,000
Completion of trial stay at Piper Boats yard:	£5,000

VAT RULES

Currently, the rules regarding our range of Dutch style barges in the UK are such that vessels that are designed and supplied for the intended use as a place of habitation are 'qualifying ships' and 'eligible for Zero-rating' for VAT. This means that the boat can be supplied with VAT charged at 0% (T0).

Our boats can be used in the EU; a non-EU flagged boat can remain continuously in the EU itself for up to 18 months without paying VAT and each time you leave the EU that 18-month clock re-starts.

Also, this eighteen month period may be extended for up to 24 months for the time during which the boat is not used as per the EU Customs Code. These rules are the same which have been applied to non UK residents such as the USA and Australia in the past.

If there is a requirement for more permanent importation, VAT can be paid on the boat in the EU on its current value (20%) so that the boat gains status as "VAT-paid". We are awaiting confirmation that this tax can be reclaimed if the boat is then exported back to the UK, at which point the applicable amount of VAT for the UK must be accounted for (0%).

SALON FLUVIAL

ST-JEAN-DE-LOSNE 2023

Piper Boats also host an annual event in Saint Jean-de-Losne, France. The event is similar to what we are doing here in Henley, a gathering for all Piper Boats customers, old and new. Another great opportunity to take a look around Piper built barges and chat to their owners.

It has the same party atmosphere, it's a celebration of what it means to be part of the Piper Boats family mais en Français! For so many of our owners, the ultimate plan is to set off across the Channel and into the French waterways, so what better place to start than at Saint-Jean-de-Losne?

You can talk to us and our owners about how and why you should take your boat and explore the waterways of Europe.

Our event is part of the Salon Fluvial international inland waterways boat show. Save the date in your calendar; we would love to see you there!

We are often in France as Piper Boats maintain a small headquarters in the town.



PIPER BOATS
SALON FLUVIAL
29-30 APRIL 2023

YOU ARE INVITED TO
THE ANNUAL PIPER
BOATS EVENT AT
SAINT-JEAN-DE-LOSNE
IN FRANCE

Discover Piper's Dutch-style boats on the water, discuss with their owners, share their experiences and meet the Piper Boats team.

To register for this event and make an appointment, please call us on
00 44 (0) 1782 510 610
or email - sales@piperboats.com

Save the Date

29-30 April 2023

Salon Fluvial International Inland

Waterways Boat Show

Saint-Jean-de-Losne, France



**LE SALON
FLUVIAL**
SAINT-JEAN-DE-LOSNE



Piper Boats Limited, 6 Prospect Way, Victoria Business Park, Biddulph, Stoke-on-Trent, ST8 7PL

t: 00 44 (0) 1782 510 610 e: sales@piperboats.com www.piperboats.com