



PIPER PRESS  
SALON FLUVIAL EDITION

---

2023

**LE SALON  
FLUVIAL**  
SAINT-JEAN-DE-LOSNE





# THE WHOLE PIPER BOATS TEAM WELCOMES YOU TO THE FLUVIAL SHOW

Welcome from Piper Boats to the Salon Fluvial at St Jean De Losne! We are excited to be here again for 2023 and to be a part of this great event for the boating community around the river Saône. Salon Fluvial is a celebration of all the things that the French inland waterways can offer and we are proud to champion all the pleasures that life on the river offers!

Boating in France is an aspiration for many water-lovers. Whether it's exploring the area's rich historical and cultural heritage, finding the best restaurants, or escaping hectic normal life – what better way than on the water? Be it a plan for retirement, a holiday in the summer or a permanent life on board – we think the best option is a Piper boat. We offer a fantastic range of Dutch barge style river boats ranging from lengths between 15m and 20m and this year, we are thrilled to offer the all new 12m Piper River Cruiser.

We launched the 12C river cruiser in the UK in 2021 and now it's time to get one into French waters! It offers something a little bit different to our Dutch barges; a completely different boat style; something that looks truly beautiful. We are incredibly proud of this new style of boat and believe it offers something different to what's currently available in the market. Piper Boats have a lot to offer to the river cruiser market – bringing our ideas and styling across from our experience with Dutch style barge building.

And we've also been busy with the development of new Dutch barge designs - We have redeveloped our 65ft motor barge for 2023 and are launching the all-new 60ft luxemotor – there really is a boat for everyone!









This is the time to explore all the different available options – what size boat? How much living space do you need? How many bedrooms? Wheelhouse with bifold doors opening onto the stern deck, or an external helm position on the upper stern deck? What colour? And what about the name?!

Whether it is working out all the answers or discovering everything that Piper Boats can offer, we have most of the available options here for you to see. So go and chat to our owners, look at the boats we've built and come and see the Piper Boats staff to discuss your dream of a wonderful new boat.

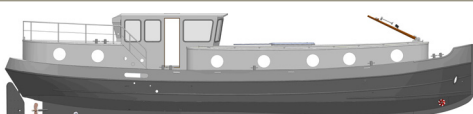
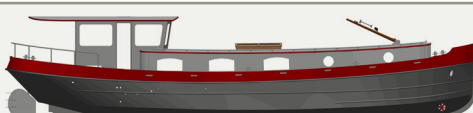

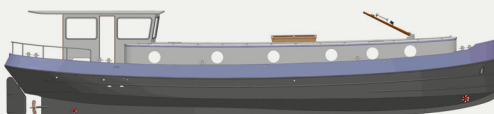

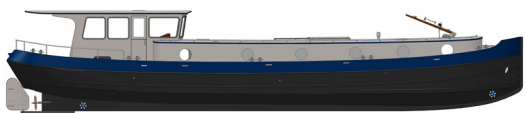
## THE PIPER BOATS RANGE

P. 4	49M MOTOR	GUIDE COST PRICE * <b>£335,000</b> 381.900 € Ex VAT ( as at 03/04/23 )	
P. 5	49L LUXEMOTOR	GUIDE COST PRICE * <b>£390,000</b> 444.600 € Ex VAT ( as at 03/04/23 )	
P. 6	55L LUXEMOTOR	GUIDE COST PRICE * <b>£430,000</b> 490.200 € Ex VAT ( as at 03/04/23 )	
P. 7	55N NIVERNAIS	GUIDE COST PRICE * <b>£325,000</b> 370.500 € Ex VAT ( as at 03/04/23 )	
P. 8	57N NIVERNAIS	GUIDE COST PRICE * <b>£350,000</b> 399.000 € Ex VAT ( as at 03/04/23 )	
P. 9	60M MOTOR	GUIDE COST PRICE * <b>£380,000</b> 421.800 € Ex VAT ( as at 03/04/23 )	
P. 10	60L LUXEMOTOR	GUIDE COST PRICE * <b>£485,000</b> 552.900 € Ex VAT ( as at 03/04/23 )	
P. 11	65L LUXEMOTOR	GUIDE COST PRICE * <b>£550,000</b> 627.000 € Ex VAT ( as at 03/04/23 )	
P. 12	65M MOTOR	GUIDE COST PRICE * <b>£430,000</b> 490.200 € Ex VAT ( as at 03/04/23 )	
P. 15	12C CRUISER	GUIDE COST PRICE * <b>£300,000</b> 342.000 € Ex VAT ( as at 03/04/23 )	



We have a fantastic selection of barges this year with eighteen taking part.  
Here is the 2023 line-up of the boats on display!



KARANJA - 49M



KARINYA - 49L

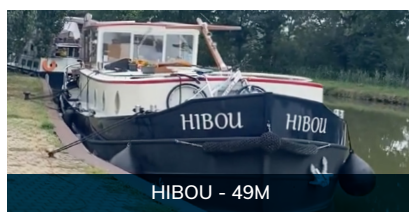

HIBOU - 49M

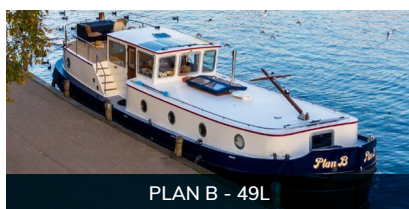

PLAN B - 49L

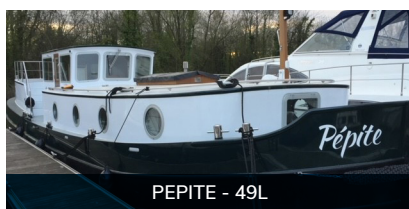

PEPITE - 49L



SOLA - 55L



QUERCY - 55N



ETHOLLE - 55N



LA FENICE - 57N



ZARATAN - 57N

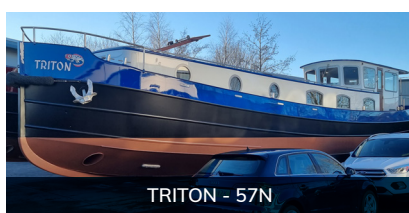

TRITON - 57N



TAMMOC II - 57N



SONGBIRD - 57N



RANGALI - 60N



LUCIE - 60N



PHANTOM - 60M

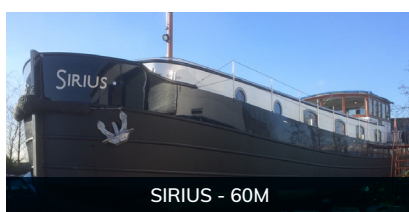

SIRIUS - 60M



CALLIOPE - 60M



You can always  
recognise a Piper boat.

Designed expertly.

Made exceptionally.



# 49M —

## MOTOR CLASS DUTCH BARGE

OVERALL LENGTH: 49FT / 14.95M  
OVERALL BEAM: 13FT 10IN / 4.23M  
AIR DRAFT: 2.95M  
DRY WEIGHT: 29 TONNE

GUIDE COST PRICE

# £335,000\*

381,900 € Ex VAT ( as at 03/04/23 )

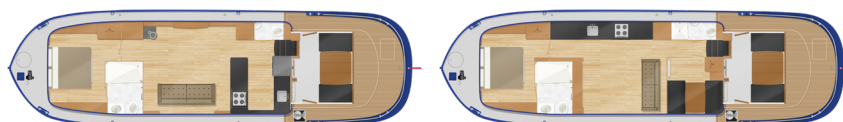
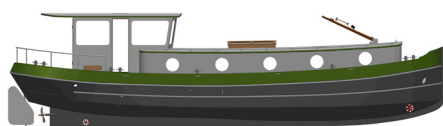

## SPECIFICATION

### HULL

- Shipbuilding Quality Grade A steel plate according to EN10204 / 3.2 LRS
- Shipbuilding plate blasted to SA 2.5 and primed by Dutch supplier
- Spray foam insulation
- 12mm keel plate
- 8mm chines & hull sides
- 6mm decks
- 5mm superstructure
- 1750L water tank with level indicator
- 1240L main propulsion fuel tank with level indicator
- 230L gravity auxiliary fuel tank with level indicator (if reflex stove installed)
- 875L black waste tank with level indicator
- 16L grey waste buffer tank with pump (divertible to black tank)

### EXTERIOR

- Stainless steel hand rails and bollards
- Jotun approved external marine paint system (choice of colours, specification available on request)
- Double glazed & thermally broke windows to wheelhouse
- Double glazed & thermally broke portholes to cabin
- Automated hardwood mast with powder coated stainless steel tabernacle
- Welded steel dog box with hardwood lining & canvas cover
- Front barge fender
- Navigation lights (port, starboard, stern, anchor, steaming) & headlight
- Basic mooring lines 14mm thick x 15m long

### ENGINE, GENERATOR & HEATING

- Beta 105hp engine with PRM 280 gearbox keel cooled
- Kabola pressure jet central heating boiler
- 50L calorifier
- 1.5kw immersion heater
- Heating via radiators
- 5kVA soundproof enclosed marine generator
- ROLLS AGM 2-volt cells in excess of 1150 a/hr (c20 rate)
- VETUS AGM batteries for thrusters & engine start
- 3kW Victron Quattro inverter/charger
- Victron Isolation Transformer 3.6kW
- Victron Battery and Remote Management system with touchscreen panel

- Twin alternators 12v
- 125kg.f electric bow thruster
- 95kg.f electric stern thruster
- Electric anchor winch

### WHEELHOUSE

- Fixed steel wheelhouse
- Lined with sapele
- Removable table with drop down leaf converts into a double bed
- Seating for 4 people
- Access to engine room via the steps under the seating

### DASH

- Raymarine 7" chart plotter with basic mapping
- Raymarine VHF Radio DSC
- RPI (Rudder Position Indicator) + Depth Gauge
- Engine panel & controls
- Thruster controls
- Hydraulic steering with bypass

### GALLEY

- Fitted with premium oak plywood
- Shaker style hardwood oak doors
- Composite work tops with waterfall edges
- Stainless steel inset sink
- Gas hob and oven with an extractor hood
- Built in microwave
- Vittrifigo marine fridge freezer 12v
- Slimline Dishwasher (Customer to supply)
- Washer/dryer (Customer to supply)
- Engineered wooden flooring
- Central heating radiator

### SALOON

- Under floor storage/cellar
- Engineered wooden flooring
- TV & Audio (Customer to supply)
- Reflex 2000KT diesel stove (stove included in one bedroom layout only)
- Large central heating radiator

### MASTER BEDROOM

- King size bed
- Cupboards and drawers to port and starboard
- Full height wardrobe

- Marine Aircon
- TV point
- Central heating radiator
- Engineered wooden flooring or carpet (customer choice)

### SECOND BEDROOM

- Second bedroom applicable to certain layouts only
- Sliding privacy hatch into saloon
- Dinette table and seating which converts to a double bed
- Overhead storage and small wardrobe
- Engineered wooden flooring or carpet (customer choice)

### ENSUITE TO MASTER BEDROOM

- Walk in shower with glass screen
- Thermostatic shower valve
- Marine remote flush toilet
- Heated towel radiator
- Vanity unit with integrated basin & waterfall edging

### DAY LOO

- Day loo applicable to certain layouts only
- Marine remote flush toilet
- Heated towel radiator
- Washbasin

### Optional one bedroom layout

\*Price is subject to the year in which the barge is to be constructed and based on Piper's annual price list.

\*\* Piper Boats reserve the right to alter the specification as required (E&OE).

\*\*\* Price quoted is excluding VAT.



# LUXEMOTOR CLASS DUTCH BARGE

# — 49 L



OVERALL LENGTH: 49FT / 14.9M  
OVERALL BEAM: 13FT 10IN / 4.23M  
AIR DRAFT: 2.925M  
DRY WEIGHT: 31 TONNE

GUIDE COST PRICE

## £390,000\*

444,600 € Ex VAT (as at 03/04/23)

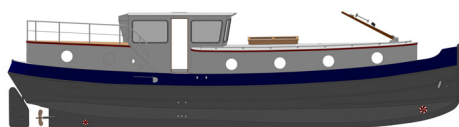

## SPECIFICATION

### HULL

- Shipbuilding Quality Grade A steel plate according to EN10204 / 3.2 LRS
- Shipbuilding plate blasted to SA 2.5 and primed by Dutch supplier
- Spray foam insulation
- 12mm keel plate
- 8mm chines & hull sides
- 6mm decks
- 5mm superstructure
- 1750L water tank with level indicator
- 1110L main propulsion fuel tank with level indicator
- 230L gravity auxiliary fuel tank with level indicator (if reflex stove installed)
- 680L black waste tank with level indicator
- 8L grey waste buffer tank with pump (divertible to black tank)

### EXTERIOR

- Stainless steel hand rails and bollards
- Jotun approved external marine paint system (choice of colours, specification available on request)
- Double glazed & thermally broke windows to wheelhouse
- Double glazed & thermally broke portholes to cabin
- Automated hardwood mast with powder coated stainless steel tabernacle
- Welded steel dog box with hardwood lining & canvas cover
- Front barge fender
- Navigation lights (port, starboard, stern, anchor, steaming) & headlight
- Basic mooring lines 14mm thick x 15m long
- Secondary helm position

### ENGINE, GENERATOR & HEATING

- Beta 105hp engine with PRM 280 gearbox raw water cooled
- Kabola pressure jet central heating boiler
- 65L calorifier
- 1.5kw immersion heater
- Heating via radiators
- 5kVA soundproof enclosed marine generator
- ROLLS AGM 2-volt cells in excess of 1150 a/hr (c20 rate)
- VETUS AGM batteries for thrusters & engine start
- 3kW Victron Quattro inverter/charger
- Victron Isolation Transformer 3.6kW
- Victron Battery and Remote Management system with touchscreen panel

- Twin alternators 12v
- 150kg.f proportional electric bow thruster
- 90kg.f proportional electric stern thruster
- Electric Anchor Winch.
- Electro-hydraulic power steering

### WHEELHOUSE

- Fixed steel wheelhouse
- Lined with sapele
- Removable table with drop down leaf converts into a double bed
- Seating for 4 people
- Access to engine room via passageway under wheelhouse

### UPPER HELM

- RPI (Rudder Position Indicator) + Depth Gauge
- Engine panel & controls
- Joystick proportional thruster controls
- Raymarine 7" chart plotter with basic mapping

### DASH

- Raymarine 7" chart plotter with basic mapping
- Raymarine VHF Radio DSC
- RPI (Rudder Position Indicator) + Depth Gauge
- Engine panel & controls
- Joystick proportional thruster controls

### GALLEY

- Fitted with premium oak plywood
- Shaker style hardwood oak doors
- Composite work tops with waterfall edges
- Stainless steel inset sink
- Gas hob and oven with an extractor hood
- Built in microwave
- Vittrifigo marine fridge freezer 12v
- Slimline Dishwasher (Customer to supply)
- Washer/dryer (Customer to supply)
- Engineered wooden flooring
- Central heating plinth heater

### SALOON

- Under floor storage/cellar
- Engineered wooden flooring
- TV & Audio (Customer to supply)
- Reflex 2000KT diesel stove (stove included in one bedroom layout only)
- Large central heating radiator

### MASTER BEDROOM

- King size bed
- Cupboards and drawers to port and starboard
- Full height wardrobe
- Marine Aircon
- TV point
- Central heating radiator
- Engineered wooden flooring or carpet (customer choice)

### SECOND BEDROOM

- Second bedroom applicable to certain layouts only
- King size bed
- Full height wardrobe
- Cupboards and drawers to port and starboard
- Marine Aircon
- TV point
- Central heating radiator
- Engineered wooden flooring or carpet (customer choice)

### ENSUITE TO MASTER BEDROOM

- 760 x 760 shower enclosure
- Thermostatic shower valve
- Marine remote flush toilet
- Heated towel radiator
- Vanity unit with integrated basin & waterfall edging edging

### ENSUITE TO SECOND BEDROOM

- Walk in shower with glass screen
- Thermostatic shower valve
- Marine remote flush toilet
- Heated towel radiator
- Vanity unit with integrated basin & waterfall edging

### DAY LOO

- Day loo applicable to certain layouts only
- Marine remote flush toilet
- Heated towel radiator
- Washbasin

### Optional one bedroom layout

\*Price is subject to the year in which the barge is to be constructed and based on Piper's annual price list.

\*\* Piper Boats reserve the right to alter the specification as required (E&OE).

\*\*\* Price quoted is excluding VAT.



# 55L — LUXEMOTOR CLASS DUTCH BARGE

OVERALL LENGTH: 55FT 9IN / 17M  
OVERALL BEAM: 13FT 11IN / 4.24M  
AIR DRAFT: 2.925M  
DRY WEIGHT: 33 TONNE

GUIDE COST PRICE

## £430,000\*

390,200 € Ex VAT ( as at 03/04/23 )

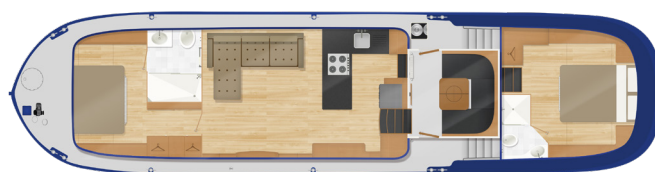
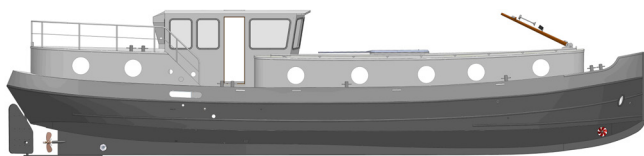

## SPECIFICATION

### HULL

- Shipbuilding Quality Grade A steel plate according to EN10204 / 3.2 LRS
- Shipbuilding plate blasted to SA 2.5 and primed by Dutch supplier
- Spray foam insulation
- 12mm keel plate
- 8mm chines & hull sides
- 6mm decks
- 5mm superstructure
- 1750L water tank with level indicator
- 1170L main propulsion fuel tank with level indicator
- 230L gravity auxiliary fuel tank with level indicator (if reflex stove installed)
- 800L black waste tank with level indicator
- 16L grey waste buffer tank with pump (divertible to black tank)

### EXTERIOR

- Stainless steel hand rails and bollards
- Jotun approved external marine paint system (choice of colours, specification available on request)
- Double glazed & thermally broke windows to wheelhouse
- Double glazed & thermally broke windows & portholes to cabin
- Automated hardwood mast with powder coated stainless steel tabernacle
- Welded steel dog box with hardwood lining & canvas cover
- Front barge fender
- Navigation lights (port, starboard, stern, anchor, steaming) & headlight
- Basic mooring lines 14mm thick x 15m long
- Secondary helm position

### ENGINE, GENERATOR & HEATING

- Vetus 120hp engine with ZF45 gearbox raw water cooled
- Kabola pressure jet central heating boiler
- 75L calorifier
- 1.5kw immersion heater
- Heating via radiators
- 5kVA soundproof enclosed marine generator
- ROLLS AGM 2-volt cells in excess of 1150 a/hr (c20 rate)
- VETUS AGM batteries for thrusters & engine start
- 3kW Victron Quattro inverter/charger
- Victron Isolation Transformer 3.6kW

- Victron Battery and Remote Management system with touchscreen panel
- Twin alternators 12v
- 150kg.f proportional electric bow thruster
- 90kg.f proportional electric stern thruster
- Electric Anchor Winch.
- Electro-hydraulic power steering

### WHEELHOUSE

- Fixed steel wheelhouse
- Lined with sapele
- Removable table with drop down leaf converts into a double bed
- Seating for 4 people
- Access to engine room via passageway under wheelhouse

### UPPER HELM

- RPI (Rudder Position Indicator) + Depth Gauge
- Engine panel & controls
- Joystick proportional thruster controls
- Raymarine 7" chart plotter with basic mapping

### DASH

- Raymarine 7" chart plotter with basic mapping
- Raymarine VHF Radio DSC
- RPI (Rudder Position Indicator) + Depth Gauge
- Engine panel & controls
- Joystick proportional thruster controls

### GALLEY

- Fitted with premium oak plywood
- Shaker style hardwood oak doors
- Composite work tops with waterfall edges
- Stainless steel inset sink
- Gas hob and oven with an extractor hood
- Built in microwave
- Vittrifigo marine fridge freezer 12v
- Slimline Dishwasher (Customer to supply)
- Washer/dryer (Customer to supply)
- Engineered wooden flooring
- Central heating plinth heater

### SALOON

- Under floor storage/cellar
- Engineered wooden flooring
- Reflex 2000KT diesel stove
- TV & Audio (Customer to supply)
- Large central heating radiator

### MASTER BEDROOM

- European King size bed
- Cupboards and drawers to port and starboard
- Full height wardrobe
- Marine Aircon
- TV point
- Central heating radiator
- Engineered wooden flooring or carpet (customer choice)

### SECOND BEDROOM

- European King size bed
- Full height wardrobe
- Cupboards and drawers to port and starboard
- Marine Aircon
- TV point
- Central heating radiator
- Engineered wooden flooring or carpet (customer choice)

### ENSUITE TO MASTER BEDROOM

- 800 x 800 shower enclosure
- Thermostatic shower valve
- Marine remote flush toilet
- Heated towel radiator
- Vanity unit with integrated basin & waterfall edging

### ENSUITE TO SECOND BEDROOM

- Walk in shower with glass screen
- Thermostatic shower valve
- Marine remote flush toilet
- Heated towel radiator
- Vanity unit with integrated basin & waterfall edging

### DAY LOO

- Day loo applicable to certain layouts only
- Marine remote flush toilet
- Heated towel radiator
- Washbasin

### Optional one-bedroom layout

\*Price is subject to the year in which the barge is to be constructed and based on Piper's annual price list.  
\*\* Piper Boats reserve the right to alter the specification as required (E&OE).

\*\*\* Price quoted is excluding VAT.



## NIVERNAIS CLASS DUTCH BARGE

# — 55N



OVERALL LENGTH: 55FT 2IN / 16.85M

OVERALL BEAM: 12FT 6IN / 3.81M

AIR DRAFT: 2.875M

WHEELHOUSE DOWN: 2M\*

DRY WEIGHT: 30 TONNE

GUIDE COST PRICE

# £325,000\*

370.500 € Ex VAT ( as at 03/04/23 )

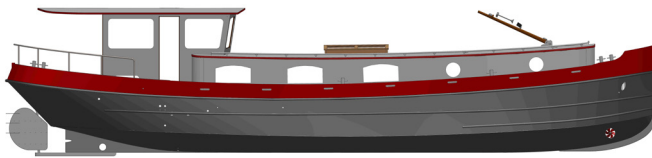

## SPECIFICATION

### HULL

- Shipbuilding Quality Grade A steel plate according to EN10204 / 3.2 LRS
- Shipbuilding plate blasted to SA 2.5 and primed by Dutch supplier
- Spray foam insulation
- 12mm keel plate
- 8mm chines & hull sides
- 6mm decks
- 5mm superstructure
- 1260L water tank with level indicator
- 1015L main propulsion fuel tank with level indicator
- 750L auxiliary fuel tank with level indicator
- 1020L black waste tank with level indicator
- 16L grey waste buffer tank with pump (divertible to black tank)

### EXTERIOR

- Stainless steel hand rails and bollards
- Jotun approved external marine paint system (choice of colours, specification available on request)
- Double glazed & thermally broke windows to wheelhouse
- Double glazed & thermally broke windows & portholes to cabin
- Automated hardwood mast with powder coated stainless steel tabernacle
- Welded steel dog box with hardwood lining & canvas cover
- Front barge fender
- Navigation lights (port, starboard, stern, anchor, steaming) & headlight
- Basic mooring lines 14mm thick x 15m long

### ENGINE & HEATING

- Beta 90hp engine with PRM 280 gearbox keel cooled
- Kabola pressure jet central heating boiler
- 75L calorifier
- 1.5kw immersion heater
- Heating via radiators
- ROLLS AGM 2-volt cells in excess of 1150 a/hr (c20 rate)
- VETUS AGM batteries for thrusters & engine start
- 3kW Victron Quattro inverter/charger
- Victron Isolation Transformer 3.6kW

- Victron Battery and Remote Management system with touchscreen panel
- Twin alternators 12v
- 125kg.f electric bow thruster
- 95kg.f electric stern thruster
- Electric anchor winch

### WHEELHOUSE

- Fixed steel wheelhouse
- Lined with sapele
- Removable table with drop down leaf converts into a double bed
- Seating for 4 people
- Access to engine room via the steps under the seating

### DASH

- Raymarine 7" chart plotter with basic mapping
- Raymarine VHF Radio DSC
- RPI (Rudder Position Indicator) + Depth Gauge
- Engine panel & controls
- Thruster controls
- Hydraulic steering with bypass

### GALLEY

- Fitted with premium oak plywood
- Shaker style hardwood oak doors
- Composite work tops with waterfall edges
- Stainless steel inset sink
- Gas hob and oven with an extractor hood
- Built in microwave
- Vittrifigo marine fridge freezer 12v
- Slimline Dishwasher (Customer to supply)
- Washer/dryer (Customer to supply)
- Engineered wooden flooring
- Central heating radiator

### SALOON

- Under floor storage/cellar
- Engineered wooden flooring
- TV & Audio (Customer to supply)
- Large central heating radiator

### MASTER BEDROOM

- King size bed
- Cupboards and drawers to port and starboard
- Full height wardrobe

- TV point
- Central heating radiator
- Engineered wooden flooring or carpet (customer choice)

### SECOND BEDROOM

- Sliding privacy hatch into saloon
- Dinette table and seating which converts to a double bed
- Overhead storage and small wardrobe
- Engineered wooden flooring or carpet (customer choice)

### MAIN BATHROOM

- 800 x 800 shower enclosure
- Thermostatic shower valve
- Marine remote flush toilet
- Vanity unit with integrated basin
- Heated towel radiator

\* Optional collapsible hardwood wheelhouse

Refleks 2000KT diesel stove available at extra cost

5kW soundproof enclosed marine generator available at extra cost

Marine aircon unit to bedroom available at extra cost

\*Price is subject to the year in which the barge is to be constructed and based on Piper's annual price list.

\*\* Piper Boats reserve the right to alter the specification as required (E&OE).

\*\*\* Price quoted is excluding VAT.



# 57N —

## NIVERNAIS CLASS DUTCH BARGE

OVERALL LENGTH: 57FT 2IN / 17.45M

OVERALL BEAM: 12FT 6IN / 3.81M

AIR DRAFT: 2.875M

WHEELHOUSE DOWN: 2M\*

DRY WEIGHT: 31 TONNE

GUIDE COST PRICE

# £350,000\*

399,000 € Ex VAT ( as at 03/04/23 )

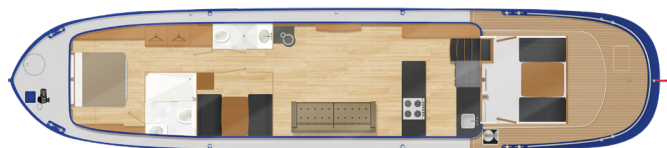
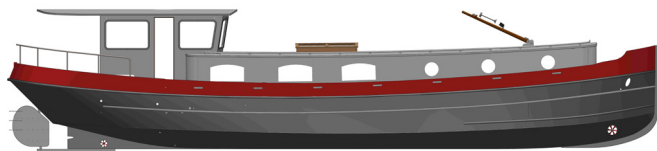

## SPECIFICATION

### HULL

- Shipbuilding Quality Grade A steel plate according to EN10204 / 3.2 LRS
- Shipbuilding plate blasted to SA 2.5 and primed by Dutch supplier
- Spray foam insulation
- 12mm keel plate
- 8mm chines & hull sides
- 6mm decks
- 5mm superstructure
- 1750L water tank with level indicator
- 600L main propulsion fuel tank with level indicator
- 1000L auxiliary fuel tank with level indicator
- 1020L black waste tank with level indicator
- 16L grey waste buffer tank with pump (divertible to black tank)

### EXTERIOR

- Stainless steel hand rails and bollards
- Jotun approved external marine paint system (choice of colours, specification available on request)
- Double glazed & thermally broke windows to wheelhouse
- Double glazed & thermally broke windows & portholes to cabin
- Automated hardwood mast with powder coated stainless steel tabernacle
- Welded steel dog box with hardwood lining & canvas cover
- Front barge fender
- Navigation lights (port, starboard, stern, anchor, steaming) & headlight
- Basic mooring lines 14mm thick x 15m long

### ENGINE, GENERATOR & HEATING

- Beta 105hp engine with PRM 280 gearbox keel cooled
- Kabola pressure jet central heating boiler
- 75L calorifier
- 1.5kw immersion heater
- Heating via radiators
- 5kVA soundproof enclosed marine generator
- ROLLIS AGM 2-volt cells in excess of 1150 a/hr (c20 rate)
- VETUS AGM batteries for thrusters & engine start
- 3kW Victron Quattro inverter/charger
- Victron Isolation Transformer 3.6kW

- Victron Battery and Remote Management system with touchscreen panel
- Twin alternators 12v
- 160kg.f electric bow thruster
- 95kg.f electric stern thruster
- Electric anchor winch

### WHEELHOUSE

- Fixed steel wheelhouse
- Lined with sapele
- Removable table with drop down leaf converts into a double bed
- Seating for 4 people
- Access to engine room via the steps under the seating

### DASH

- Raymarine 7" chart plotter with basic mapping
- Raymarine VHF Radio DSC
- RPI (Rudder Position Indicator) + Depth Gauge
- Engine panel & controls
- Thruster controls
- Hydraulic steering with bypass

### GALLEY

- Fitted with premium oak plywood
- Shaker style hardwood oak doors
- Composite work tops with waterfall edges
- Stainless steel inset sink
- Gas hob and oven with an extractor hood
- Built in microwave
- Vitfrigo marine fridge freezer 12v
- Slimline Dishwasher (Customer to supply)
- Washer/dryer (Customer to supply)
- Engineered wooden flooring
- Central heating radiator

### SALOON

- Under floor storage/cellar
- Engineered wooden flooring
- Refleks 2000KT diesel stove
- TV & Audio (Customer to supply)
- Large central heating radiator

### MASTER BEDROOM

- King size bed
- Cupboards and drawers to port and starboard
- Full height wardrobe

- Marine Aircon
- TV point
- Central heating radiator
- Engineered wooden flooring or carpet (customer choice)

### SECOND BEDROOM

- Sliding privacy hatch into saloon
- Dinette table and seating which converts to a double bed
- Overhead storage and small wardrobe
- Engineered wooden flooring or carpet (customer choice)

### ENSUITE TO MASTER BEDROOM

- Walk in shower with glass screen
- Thermostatic shower valve
- Marine remote flush toilet
- Heated towel radiator
- Vanity unit with integrated basin & waterfall edging

### MAIN BATHROOM

- 800 x 800 shower tray wetroom
- Thermostatic shower valve
- Marine remote flush toilet
- Vanity unit with integrated basin
- Heated towel radiator

\*Optional collapsible hardwood wheelhouse

\*Price is subject to the year in which the barge is to be constructed and based on Piper's annual price list.

\*\* Piper Boats reserve the right to alter the specification as required (E&OE).

\*\*\* Price quoted is excluding VAT.



## MOTOR CLASS DUTCH BARGE

# — 60M



OVERALL LENGTH: 60FT / 18.3M  
OVERALL BEAM: 13FT 10IN / 4.23M  
AIR DRAFT: 2.975M  
WHEELHOUSE DOWN: 2M\*  
DRY WEIGHT: 35 TONNE

GUIDE COST PRICE

# £370,000\*

421.800 € Ex VAT ( as at 03/04/23 )

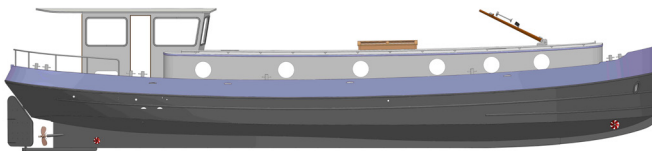

## SPECIFICATION

### HULL

- Shipbuilding Quality Grade A steel plate according to EN10204 / 3.2 LRS
- Shipbuilding plate blasted to SA 2.5 and primed by Dutch supplier
- Spray foam insulation
- 12mm keel plate
- 8mm chines & hull sides
- 6mm decks
- 5mm superstructure
- 1870L water tank with level indicator
- 800L main propulsion fuel tank with level indicator
- 1000L auxiliary fuel tank with level indicator
- 805L black waste tank with level indicator
- 16L grey waste buffer tank with pump (divertible to black tank)

### EXTERIOR

- Stainless steel hand rails and bollards
- Jotun approved external marine paint system (choice of colours, specification available on request)
- Double glazed & thermally broke windows to wheelhouse
- Double glazed & thermally broke portholes to cabin
- Automated hardwood mast with powder coated stainless steel tabernacle
- Welded steel dog box with hardwood lining & canvas cover
- Front barge fender
- Navigation lights (port, starboard, stern, anchor, steaming) & headlight
- Basic mooring lines 14mm thick x 15m long

### ENGINE, GENERATOR & HEATING

- Beta 115hp engine with PRM 280 gearbox keel cooled
- Kabola pressure jet central heating boiler
- 75L calorifier
- 1.5kw immersion heater
- Heating via radiators
- 5kVA soundproof enclosed marine generator
- ROLLS AGM 2-volt cells in excess of 1150 a/hr (c20 rate)
- VETUS AGM batteries for thrusters & engine start
- 3kW Victron Quattro inverter/charger
- Victron Isolation Transformer 3.6kW
- Victron Energy Orion-Tr Smart 12/12V 18A DC-DC
- Victron Battery and Remote Management system with touchscreen panel

- Twin alternators 12v
- 160kg.f electric bow thruster
- 95kg.f electric stern thruster
- Electric anchor winch

### WHEELHOUSE

- Fixed steel wheelhouse
- Lined with sapele
- Removable table with drop down leaf converts into a double bed
- Seating for 4 people
- Access to engine room via the steps under the seating

### DASH

- Raymarine 7" chart plotter with basic mapping
- Raymarine VHF Radio DSC
- RPI (Rudder Position Indicator) + Depth Gauge
- Engine panel & controls
- Thruster controls
- Hydraulic steering with bypass

### GALLEY

- Fitted with premium oak plywood
- Shaker style hardwood oak doors
- Composite work tops with waterfall edges
- Stainless steel inset sink
- Gas hob and oven with an extractor hood
- Built in microwave
- Vitrefrigo marine fridge freezer 12v
- Slimline Dishwasher (Customer to supply)
- Washer/dryer (Customer to supply)
- Engineered wooden flooring
- Under floor storage/cellar
- Central heating radiator

### SALOON

- Under floor storage/cellar
- Engineered wooden flooring
- Refleks 2000KT diesel stove
- TV & Audio (Customer to supply)
- Large central heating radiator

### MASTER BEDROOM

- King size bed
- Cupboards and drawers to port and starboard
- Full height wardrobe
- Marine Aircon

- TV point
- Central heating radiator
- Engineered wooden flooring or carpet (customer choice)

### SECOND BEDROOM

- Twin single beds with drawer storage underneath
- Overhead storage and small wardrobe
- Central heating radiator
- Engineered wooden flooring or carpet (customer choice)

### ENSUITE TO MASTER BEDROOM

- Walk in shower with glass screen
- Thermostatic shower valve
- Marine remote flush toilet
- Heated towel radiator
- Vanity unit with integrated basin & waterfall edging

### DAY LOO

- Marine remote flush toilet
- Heated towel radiator
- Washbasin
- Compact 700 x 800 shower enclosure

### Optional one bedroom layout

### \*Optional collapsible hardwood wheelhouse

\*Price is subject to the year in which the barge is to be constructed and based on Piper's annual price list.

\*\* Piper Boats reserve the right to alter the specification as required (E&OE).

\*\*\* Price quoted is excluding VAT.



# 60L — LUXEMOTOR CLASS DUTCH BARGE

OVERALL LENGTH: 60FT / 18.3M  
OVERALL BEAM: 14FT 9IN / 4.5M  
AIR DRAFT: 3M  
DRY WEIGHT: 36 TONNES

GUIDE COST PRICE

**£485,000\***

552.900 € Ex VAT ( as at 03/04/23 )

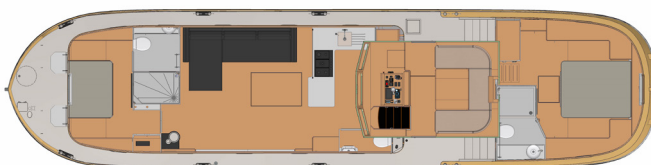

## SPECIFICATION

### HULL

- Shipbuilding Quality Grade A steel plate according to EN10204 / 3.2 LRS
- Shipbuilding plate blasted to SA 2.5 and primed by Dutch supplier
- Spray foam insulation
- 12mm keel plate
- 8mm chines & hull sides
- 6mm decks
- 5mm superstructure
- 1400L water tank with level indicator
- 1400L main propulsion fuel tank with level indicator
- 230L auxiliary fuel tank with level indicator
- 900L black waste tank with level indicator
- 16L grey waste buffer tank with pump (divertible to black tank)

### EXTERIOR

- Stainless steel hand rails and bollards
- Jotun approved external marine paint system (choice of colours, specification available on request)
- Double glazed & thermally broke windows to wheelhouse
- Double glazed & thermally broke windows & portholes to cabin
- Automated hardwood mast with powder coated stainless steel tabernacle
- Welded steel dog box with hardwood lining & canvas cover
- Front barge fender
- Navigation lights (port, starboard, stern, anchor, steaming) & headlight
- Basic mooring lines 14mm thick x 15m long
- Secondary helm position

### ENGINE, GENERATOR & HEATING

- Vetus 140hp engine with ZF45 gearbox raw water cooled
- Kabola pressure jet central heating boiler
- 75L calorifier
- 1.5kw immersion heater
- Heating via radiators
- 5kVA soundproof enclosed marine generator
- ROLLS AGM 2-volt cells in excess of 1150 a/hr (c20 rate)
- VETUS AGM batteries for thrusters & engine start
- 3kW Victron Quattro inverter/charger
- Victron Isolation Transformer 3.6kW

- Victron Battery and Remote Management system with touchscreen panel
- Twin alternators 12v
- 150kg.f proportional electric bow thruster
- 90kg.f proportional electric stern thruster
- Electric Anchor Winch.
- Electro-hydraulic power steering

### WHEELHOUSE

- Fixed steel wheelhouse
- Lined with sapele
- Removable table with drop down leaf converts into a double bed
- Seating for 4 people
- Access to engine room via passageway under wheelhouse

### UPPER HELM

- RPI (Rudder Position Indicator) + Depth Gauge
- Engine panel & controls
- Joystick proportional thruster controls
- Raymarine 7" chart plotter with basic mapping

### DASH

- Raymarine 7" chart plotter with basic mapping
- Raymarine VHF Radio DSC
- RPI (Rudder Position Indicator) + Depth Gauge
- Engine panel & controls
- Joystick proportional thruster controls

### GALLEY

- Fitted with premium oak plywood
- Shaker style hardwood oak doors
- Composite work tops with waterfall edges
- Stainless steel inset sink
- Gas hob and oven with an extractor hood
- Built in microwave
- Vitfrigo marine fridge freezer 12v
- Slimline Dishwasher (Customer to supply)
- Washer/dryer (Customer to supply)
- Engineered wooden flooring
- Central heating plinth heater / radiator

### SALOON

- Under floor storage/cellar
- Engineered wooden flooring
- Refleks 2000KT diesel stove
- TV & Audio (Customer to supply)
- Large central heating radiator

### MASTER BEDROOM

- European King size bed
- Cupboards and drawers to port and starboard
- Full height wardrobe
- Marine Aircon
- TV point
- Central heating radiator
- Engineered wooden flooring or carpet (customer choice)

### SECOND BEDROOM

- European King size bed / convertible settee
- Full height wardrobe
- Cupboards and drawers to port and starboard
- Marine Aircon
- TV point
- Central heating radiator
- Engineered wooden flooring or carpet (customer choice)

### ENSUITE TO MASTER BEDROOM

- Walk in shower with glass screen
- Thermostatic shower valve
- Marine remote flush toilet
- Heated towel radiator
- Vanity unit with integrated basin & waterfall edging

### ENSUITE TO 2ND BEDROOM / DAY LOO

- 1100 x 900 shower enclosure
- Thermostatic shower valve
- Marine remote flush toilet
- Heated towel radiator
- Vanity unit with integrated basin & waterfall edging

### DAY LOO

- Day loo applicable to certain layouts only
- Marine remote flush toilet
- Heated towel radiator
- Washbasin

\*Price is subject to the year in which the barge is to be constructed and based on Piper's annual price list.

\*\* Piper Boats reserve the right to alter the specification as required (E&OE).

\*\*\* Price quoted is excluding VAT.

## LUXEMOTOR CLASS DUTCH BARGE

# — 65L



OVERALL LENGTH: 65FT 6IN / 19.8M

OVERALL BEAM: 14FT 9IN / 4.5M

AIR DRAFT: 3M

DRY WEIGHT: 39 TONNE

GUIDE COST PRICE

# £550,000\*

627.000 € Ex VAT ( as at 03/04/23 )

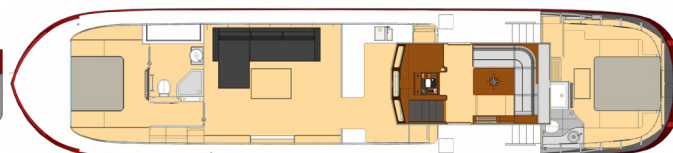
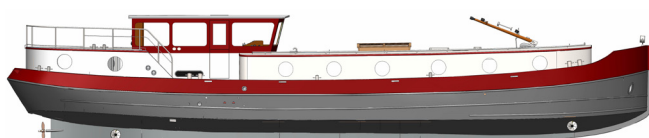

## SPECIFICATION

### HULL

- Shipbuilding Quality Grade A steel plate according to EN10204 / 3.2 LRS
- Shipbuilding plate blasted to SA 2.5 and primed by Dutch supplier
- Spray foam insulation
- 12mm keel plate
- 8mm chines & hull sides
- 6mm decks
- 5mm superstructure
- 1870L water tank with level indicator
- 1240L main propulsion fuel tank with level indicator
- 1150L auxiliary fuel tank with level indicator
- 875L black waste tank with level indicator
- 16L grey waste buffer tank with pump (divertible to black tank)

### EXTERIOR

- Stainless steel hand rails and bollards
- Jotun approved external marine paint system (choice of colours, specification available on request)
- Double glazed & thermally broke windows to wheelhouse
- Double glazed & thermally broke portholes to cabin
- Automated hardwood mast with powder coated stainless steel tabernacle
- Welded steel dog box with hardwood lining & canvas cover
- Front barge fender
- Navigation lights (port, starboard, stern, anchor, steaming) & headlight
- Basic mooring lines 14mm thick x 15m long
- Secondary helm position

### ENGINE, GENERATOR & HEATING

- Vetus 140hp engine with ZF45 gearbox raw water cooled
- Kabola pressure jet central heating boiler
- 75L calorifier
- 1.5kw immersion heater
- Heating via radiators
- 7kVA soundproof enclosed marine generator
- ROLLS AGM 2-volt cells in excess of 1150 a/hr (c20 rate)
- VETUS AGM batteries for thrusters & engine start
- 3kW Victron Quattro inverter/charger
- Victron Isolation Transformer 3.6kW
- Victron Battery and Remote Management system with touchscreen panel

- Twin alternators 12v
- 210kg.f proportional electric bow thruster
- 150kg.f proportional electric stern thruster
- Electric Anchor Winch.
- Electro-hydraulic power steering

### WHEELHOUSE

- Fixed steel wheelhouse
- Lined with sapele
- Removable table with drop down leaf converts into a double bed
- Seating for 6 people
- Access to engine room via passageway under wheelhouse

### UPPER HELM

- RPI (Rudder Position Indicator) + Depth Gauge
- Engine panel & controls
- Joystick proportional thruster controls
- Raymarine 7" chart plotter with basic mapping
- Power steering

### DASH

- Raymarine 7" chart plotter with basic mapping
- Raymarine VHF Radio DSC
- RPI (Rudder Position Indicator) + Depth Gauge
- Engine panel & controls
- Joystick proportional thruster controls

### GALLEY

- Fitted with premium oak plywood
- Shaker style hardwood oak doors
- Composite work tops with waterfall edges
- Stainless steel inset sink
- Gas hob and oven with an extractor hood
- Built in microwave
- Vittrifigo marine fridge freezer 12v
- Slimline Dishwasher (Customer to supply)
- Washer/dryer (Customer to supply)
- Engineered wooden flooring
- Central heating radiator

### SALOON

- Under floor storage/cellar
- Engineered wooden flooring
- Refleks 2000KT diesel stove
- TV & Audio (Customer to supply)
- Large central heating radiator

### MASTER BEDROOM

- European King size bed
- Cupboards and drawers to port and starboard
- Full height wardrobe
- Marine Aircon
- TV point
- Central heating radiator
- Engineered wooden flooring or carpet (customer choice)

### SECOND BEDROOM

- European King size bed
- Full height wardrobe
- Cupboards and drawers to port and starboard
- Marine Aircon
- TV point
- Central heating radiator
- Engineered wooden flooring or carpet (customer choice)

### ENSUITE TO MASTER BEDROOM

- Large shower enclosure
- Thermostatic shower valve
- Marine remote flush toilet
- Heated towel radiator
- Vanity unit with integrated basin & waterfall edging

### ENSUITE TO SECOND BEDROOM

- Walk in shower with glass screen
- Thermostatic shower valve
- Marine remote flush toilet
- Heated towel radiator
- Vanity unit with integrated basin & waterfall edging

### DAY LOO

- Day loo applicable to certain layouts only
- Marine remote flush toilet
- Heated towel radiator
- Washbasin

\*Price is subject to the year in which the barge is to be constructed and based on Piper's annual price list.

\*\* Piper Boats reserve the right to alter the specification as required (E&OE).

\*\*\* Price quoted is excluding VAT.



# 65M —

## MOTOR CLASS DUTCH BARGE

OVERALL LENGTH: 65FT 6IN / 19.9M

OVERALL BEAM: 14FT 9IN / 4.5M

AIR DRAFT: 3M

DRY WEIGHT: 38 TONNE

GUIDE COST PRICE

# £430,000\*

490.200 € Ex VAT ( as at 03/04/23 )

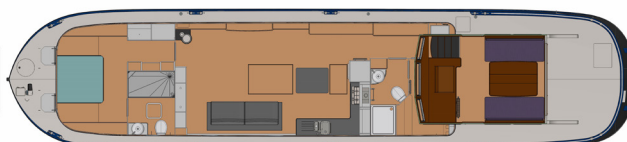
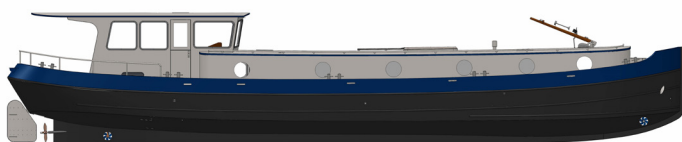

## SPECIFICATION

### HULL

- Shipbuilding Quality Grade A steel plate according to EN10204 / 3.2 LRS
- Shipbuilding plate blasted to SA 2.5 and primed by Dutch supplier
- Spray foam insulation
- 12mm keel plate
- 8mm chines & hull sides
- 6mm decks
- 5mm superstructure
- 1870L water tank with level indicator
- 800L main propulsion fuel tank with level indicator
- 1100L auxiliary fuel tank with level indicator
- 910L black waste tank with level indicator
- 16L grey waste buffer tank with pump (divertible to black tank)

### EXTERIOR

- Stainless steel hand rails and bollards
- Jotun approved external marine paint system (choice of colours, specification available on request)
- Double glazed & thermally broke windows to wheelhouse
- Double glazed & thermally broke windows & portholes to cabin
- Automated hardwood mast with powder coated stainless steel tabernacle
- Welded steel dog box with hardwood lining & canvas cover
- Front barge fender
- Navigation lights (port, starboard, stern, anchor, steaming) & headlight
- Basic mooring lines 14mm thick x 15m long

### ENGINE, GENERATOR & HEATING

- Vetus 140hp engine with ZF45A gearbox raw water cooled
- Kabola pressure jet central heating boiler
- 75L calorifier
- 1.5kw immersion heater
- Heating via radiators
- 7kVA soundproof enclosed marine generator
- ROLLS AGM 2-volt cells in excess of 1150 a/hr (c20 rate)
- VETUS AGM batteries for thrusters & engine start
- 3kW Victron Quattro inverter/charger
- Victron Isolation Transformer 3.6kW

- Victron Battery and Remote Management system with touchscreen panel
- Twin alternators 12v
- 210kg.f proportional electric bow thruster
- 150kg.f proportional electric stern thruster
- Electric anchor winch

### WHEELHOUSE

- Fixed steel wheelhouse
- Lined with sapele
- Removable table with drop down leaf converts into a double bed
- Seating for 4-6 people
- Access to engine room via the steps under the seating

### DASH

- Raymarine 7" chart plotter with basic mapping
- Raymarine VHF Radio DSC
- RPI (Rudder Position Indicator) + Depth Gauge
- Engine panel & controls
- Joystick proportional thruster controls
- Hydraulic steering with bypass

### GALLEY

- Fitted with premium oak plywood
- Shaker style hardwood oak doors
- Composite work tops with waterfall edges
- Stainless steel inset sink
- Gas hob and oven with an extractor hood
- Built in microwave
- Vitrefrigo marine fridge freezer 12v
- Slimline Dishwasher (Customer to supply)
- Washer/dryer (Customer to supply)
- Engineered wooden flooring
- Central heating radiator

### SALOON

- Under floor storage/cellar
- Engineered wooden flooring
- Refleks 2000KT diesel stove
- TV & Audio (Customer to supply)
- Large central heating radiator

### MASTER BEDROOM

- European King size bed
- Cupboards and drawers to port and starboard
- Full height wardrobe

- Marine Aircon
- TV point
- Central heating radiator
- Engineered wooden flooring or carpet (customer choice)

### SECOND BEDROOM

- Twin single beds with drawer storage underneath
- Overhead storage and small wardrobe
- Central heating radiator
- Engineered wooden flooring or carpet (customer choice)

### THIRD BEDROOM

- Bunk beds (Bottom bunk pulls out into a double)
- Full height wardrobe
- Storage cupboards and drawers
- Engineered wooden flooring or carpet (customer choice)

### ENSUITE TO MASTER BEDROOM

- Walk in shower with glass screen
- Thermostatic shower valve
- Marine remote flush toilet
- Heated towel radiator
- Vanity unit with integrated basin & waterfall edging

### DAY LOO

- Marine remote flush toilet
- Heated towel radiator
- Washbasin

Optional two bedroom layout with spacious saloon, side cabin bedroom with office space and large ensuite/dayloo

\*Price is subject to the year in which the barge is to be constructed and based on Piper's annual price list.

\*\* Piper Boats reserve the right to alter the specification as required (E&OE).

\*\*\* Price quoted is excluding VAT.





## BESPOKE INTERIOR DESIGNS

Each boat is unique,  
with its own  
characteristics and qualities



INTRODUCING THE NEW

# PIPER 12C CRUISER

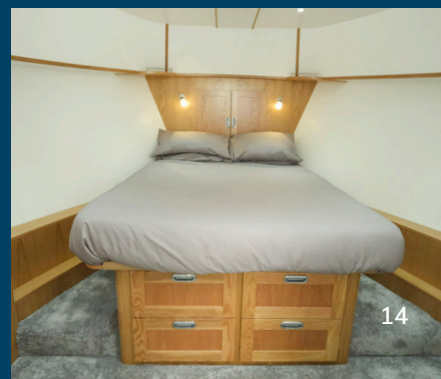



# 12C

## MOTOR RIVER CRUISER

OVERALL LENGTH 11.98M

OVERALL BEAM 4.02M

AIR DRAFT 2.77M

DRAFT 0.92M

GUIDE COST PRICE

**£300,000\***

342.000 € Ex VAT ( as at 03/04/23 )



## SPECIFICATION

### HULL

- Shipbuilding Quality Grade A steel plate according to EN10204 / 3.2 LRS
- Shipbuilding plate blasted to SA 2.5 and primed by Dutch supplier
- Spray foam insulation
- 12mm keel bar
- 6mm chines, hull sides & decks
- 4mm superstructure
- 650L water tank with level indicator
- 650L main propulsion fuel tank with level indicator
- 215L black waste tank with level indicator
- 8L grey waste buffer tank with pump

### EXTERIOR

- Stainless steel hand rails and bollards
- Jotun approved external marine paint system (choice of colours, specification available on request)
- Double glazed & thermally broke windows to wheelhouse
- Double glazed & thermally broke windows to cabin
- Hardwood mast with stainless steel tabernacle
- Webasto electric sliding sunroof in wheelhouse
- U shaped fixed seating at stern deck
- Marine rubbing strakes
- Navigation lights & headlight
- Basic mooring lines 14mm thick x 15m long

### ENGINE, GENERATOR & HEATING

- Beta marine 85T engine with TMC 345 gearbox (hybrid engine possible as request)
- Wallas 30GB Diesel Heater
- 65L calorifier
- 1.5kw immersion heater
- ROLLS AGM 2-volt cells in excess of 1400 a/hr (c20 rate)
- VETUS AGM batteries for thrusters & engine start
- 3kW Victron Quattro inverter/charger
- Victron Isolation Transformer 3.6kW



- Victron Battery and Remote Management system with controls on MFD display
- PV panels with Victron solar regulators
- Twin alternators 12v
- 90kg.f proportional electric bow thruster
- 76kg.f proportional electric stern thruster
- Electric Anchor Winch
- Hydraulic steering with bypass

### WHEELHOUSE

- Fixed steel wheelhouse with hardwood bifold doors to stern
- U shaped seating for 4 people with table
- Bench seating to portside

### WHEELHOUSE HELM/DASH

- RPI (Rudder Position Indicator) + Depth Gauge
- Engine panel & controls
- Joystick proportional thruster controls
- Raymarine 7" chart plotter with basic mapping
- Raymarine VHF Radio DSC
- Sliding door to portside by helm

### GALLEY

- Fitted with premium oak plywood
- Shaker style hardwood oak doors
- Composite work tops with waterfall edges
- Stainless steel inset sink
- Electric hob and oven with an extractor hood

- Built in microwave
- Vittrifigo marine fridge freezer 12v
- Slimline Dishwasher (Customer to supply)
- Karndean LVT flooring

### MASTER BEDROOM

- UK double size bed
- Cupboards and drawers to port and starboard
- Full height wardrobe
- Engineered wooden flooring or carpet (customer choice)

### ENSUITE/DAYLOO

- 900 x 700 shower enclosure
- Access from passageway and master bedroom
- Thermostatic shower valve
- Marine remote flush toilet
- Electric heated towel radiator
- Vanity unit with integrated basin & waterfall edging

*Optional one-bedroom layout with side cabin and bunkbeds*

\*Price is subject to the year in which the barge is to be constructed and based on Piper's annual price list.

\*\* Piper Boats reserve the right to alter the specification as required (E&OE).

\*\*\* Price quoted is excluding VAT.







# THE CUSTOMISATION OF YOUR DUTCH BARGE

Piper Boats believe that every boat we build has an excellent specification.

From the layout to the components used, there has been considerable thought into how the boat works and how it will be used.

There is no necessity to spend money on upgrades unless you want extra features or functionality over and above what Piper Boats believe to be necessary.

That said; Piper Boats understand that every boat owner has their own ideas and their own vision. We have the ability to provide your boat with custom configurations and components where requested.







## Here is a list of some of the extra components and upgrades that we have done for our existing owners:

### Layout Redesign – Custom configuration of galley units & components:

- Design changes resulting from request for different positions for galley components e.g. Fridge/oven
- Increasing the size of the galley or changing the position/size of cupboards/drawer units".....£700

### Layout Redesign – Changes to bathroom/cabin/saloon layout

- Price dependent on the quantity of bespoke design required. Bespoke requests might include:
- Repositioning of bulkheads
- Design of bespoke units and fixtures
- Inclusion of new components
- New layouts for ensuite/dayloo/saloon/front cabin.....£1,500-5,000

Engine upgrade (upgrade to VETUS VD.140HP from Beta engine).....£7,500

400w Solar Panel fitout (4 x 100w semi flexible solar panels and solar regulator).....£2,000

800w Solar Panel fitout (8 x 100w semi flexible solar panels and solar regulator).....£3,500

Upgrade to 7kW generator.....£1,000

Upgrade of alternator to Balmar 170A alternator.....£1,650

Remote control for bow/stern thruster.....£450

BOWPRO Proportional joystick controlled bow/stern thrusters.....£3,000

Upgrade chartplotter from 7" screen to 9" screen.....£300

Upgrade to 5kW inverter.....£1,200

Lithium battery pack upgrade - approx 15kW.....£10,000

Upgrade of VHF radio to include AIS receiver capability.....£350

Installation of Oyster 85cm Twin LNB Auto Skew Automatic Satellite System.....£3,300

Installation of autopilot navigation equipment.....£2,700

Installation of another air conditioning system into rear cabin/saloon (6000 BTU).....£3,500

Installation of another air conditioning system into rear cabin/saloon (12000 BTU).....£4,500

Coppercoat antifouling (price dependent on length of boat).....£3,000 - £4,000

Black painted antifouling (price dependent on length of boat).....£2,000 - £3,000

Venetian blinds in wheelhouse (roman blinds included in front cabin).....£950

Colour painting of D-bar on cabin side and wheelhouse roof.....£600

Top plank striped paint scheme.....£1,000

Colour painting of wheelhouse.....£600

Solid handrailing around side decks of boat in stainless steel tube.....£4,000

Piper Boats pivoting bike rack.....£1,400

Synthetic marine teak decking to fit the external side decks

- Dependent on boat length (stern deck synthetic marine teak decking is included in the boat price).....POA

Delivery of barge direct to St Jean De Losne.....£8,000

Crane lift at St Jean De Losne.....£3,000

We are happy to discuss your bespoke boat, please make an appointment if there is something you would like to discuss!

# THE CUSTOMER JOURNEY WITH PIPER BOATS

Piper Boats understand that commissioning a barge can be quite a daunting experience. Building a barge can be a very complex process, with different requirements & desires to be taken account of. It is the mission of Piper Boats to help guide our customers through the 'journey' from initial concept to boat launch.

We all want to have a smooth and considered build with minimum trouble; it is a matter of cooperation to make this happen.

It can be difficult to appreciate how to set out your vision for your Piper barge, the following schedule should help you understand what it is all about.

## ORDERING A PIPER BOAT

You are commissioning a Piper Boat and you will have decided which model best suits your needs. All our barges are built to order, and we have an approximate waiting list of 12-18 months dependent on season. Sometimes we can make an exception if a customer has a special schedule!

You will place an order with Piper Boats and pay a deposit which will secure the slot for you.

## A STANDARD BOAT

All customers buy the standard boat at order stage. This means that the boat price has a number of components & fixtures included within it which form part of a 'standard specification'.

Most customers have visited and seen our previously built boats before and have an idea of the layout, but Piper Boats will send an example drawing which gives an impression of the layout and components.

## THE SPECIFICATION

The next milestone is for Piper Boats and you to agree to the final specification for the boat. Normally, you will visit our workshop and chat with us about anything which you



require extra to the standard specification.

There will invariably be a list of extra components and inclusions that you are interested in. When this has been quantified, we will produce a 'build specification'.

## STEELWORK

The steelwork plates will be ordered, and we will start manufacture. All the steelwork required for your boat is cut out using a CNC machine. The first process is to lay the base plate and intermediate frames. Then the chines and hull can be welded in place. The decks and cabin will be installed, and it will start to look like a Dutch style barge!

Once the wheelhouse has been put in place, there is finally a lot of welding to do! It will take around 8 weeks for us to build the complete steelwork.

## PAINTING

The barge will be painted throughout its journey through the workshop. The first stages will be done after steelwork is complete. The external surfaces will be shot blasted and primed, ready for our paint system. The internal steelwork will be painted before any first fix plumbing, wiring and woodwork is started.

During the internal fitout, the paint will be applied to the exterior of the boat in black and a colour of the customer's choice. A paint specification is available on request.

## FITOUT

You will have a chance to review the internal design of the barge with the design team prior to any manufacturing



work being started. The design will encompass any of the individual ideas that you have, and any components which make your barge bespoke in nature. Once the design is complete, all the wooden panels are CNC manufactured in our workshop, which makes the manufacturing very precise.

The plumbing and wiring are completed as part of the 'first fix' fitout. Before we start assembling all the bulkheads, the boat is insulated with spray foam. Over the course of approximately 8 weeks, the boat will be fitted to your specification and layout. The engineering will be completed during this time and all components will be commissioned and made ready for launch.

### OVERNIGHT STAY AND ACCEPTANCE

Once the boat has been completed, you will be invited to come and review the boat before it is launched. This will normally involve an overnight stay at our workshop and give you a chance to check all of the work that has been completed and also have a chance to learn about some of the systems and components which have been installed on your boat.

### LAUNCH

Approximately a week after your overnight stay, Piper Boats will arrange transport and craneage to launch your boat in the water. Typically, this will be a Thames & Kennet Marina but it has been known for some customers to launch their boat directly into France or Belgium! The boat will go through some launch trials and be commissioned before being handed over to its new owners!

Now the dream is finally made real, your boat is ready for use and you are free to cruise the waterways!

### PAYING FOR YOUR BOAT

Payments for your boat are staged throughout the build in approximately the following way:

<b>EXAMPLE PRICE :-</b>	<b>430 000 €</b>
Deposit:	10,000 €
Start of steelwork:	70,000 €
Completion of steelwork:	75,000 €
Completion of line out & installation of bulkheads:	75,000 €
Substantial completion of fit out:	90,000 €
Completion of build prior to delivery:	105,000 €
Completion of trial stay at Piper Boats yard:	5,000 €

### VAT RULES

Currently, the rules regarding our range of Dutch style barges in the UK are such that vessels that are designed and supplied for the intended use as a place of habitation are 'qualifying ships' and 'eligible for Zero-rating' for VAT. This means that the boat can be supplied with VAT charged at 0% (T0).

Our boats can be used in the EU; a non-EU flagged boat can remain continuously in the EU itself for up to 18 months without paying VAT and each time you leave the EU that 18-month clock re-starts.

If there is a requirement for more permanent importation, VAT can be paid on the boat in the EU on its current value (20%) so that the boat gains status as "VAT-paid".

Piper Boats can arrange the importation process for you and help with the registration of your boat at your country of choice.





## OWNER'S ARTICLE: EAWYNN: THE OWNER'S TALE

As we totter down the street, to the casual observer we might seem to be reasonably responsible adults, if a little frayed around the edges. That would be a bad misjudgement, however. As will become apparent, there exists a deep character flaw, at least where boats are concerned.

We are in fact inveterate boaters and Eawynn, a 55L Piper replica barge, is the eleventh boat we have owned in the last 45 years, and our second Piper.

After thirty years or so of sailing a series of small and larger sea boats, we finally displayed a modicum of civilised behaviour and migrated to the inland waterways. Two narrowboats and several canals later, in 2015 we bought our first Piper, a 65M named Eadlin, and moved onto the Thames. After enjoying seven fantastic years of Thames cruising between London and Oxford, we were quite certain that the Dutch barge brought together all that we seek in a floating home and recreational cruiser, and that we wanted to carry on doing more of the same for as long as possible.

And then – in the space of 10 minutes, one memorable day in February 2022, we placed an order for a second Piper, this time a 55L. Although we have never regretted this decision, it would be fair to say that it came as quite a surprise to us at the time! So how did it happen?

Well, when we made the appointment to see Simon Piper and his team, we had a completely different agenda in mind. What we actually intended to do was to 'explore the pros and cons' of two options, namely to refurbish Eadlin, or to commission a new Piper. We had come to Biddulph prepared with a list of possible improvements to the 65M, plus some 'what if' thoughts about buying a second Piper.



In the event, in what can only really be described as an 'ambush', Simon and Nick rapidly persuaded us that it would be a far, far better thing altogether to allow them to build us a shiny new boat. They showed us round the current boats in build and talked us through the advances to be had in buying a new boat. They sealed the deal by offering to start the build more or less straight away, with the launch date just in time for the new boat to be on display at the Piper boat show event at Temple Island, Henley in September. Not for the first time where boats are concerned, we were utterly beguiled, succumbed rapidly to the impulse of the moment, declared it had to be a new build, and signed up accordingly.



The remaining issue was whether to choose an M class at 60ft. or a 55ft. L class (with the raised aft deck and cabin below). We knew, from conversations with our very helpful Piper owning friends at Harleyford Marina, that both models possess great features. This made it difficult to choose between them but in the end we decided that the 55L, with its elevated aft deck, dual steering positions and two ensuite double bedrooms would best suit our current lifestyle. Although we had loved every minute of cruising on Eadlin, and appreciated the additional living space that comes with a 65M, we realised that we no longer needed a third bedroom-cum-office. We are particularly attracted to the 55L design because it gives a very good view when steering from 'upstairs', and the aft deck is excellent for relaxing and entertaining friends.

Over the summer of 2022, we enjoyed many a visit to Piper's works to discuss design details and see our new boat take shape. As we experienced with our first Piper, this was one of the best bits of the project. We had plenty of time to do this, as we had sold Eadlin by early July, rendering us 'boatless' for the first time in a very long while.

Eawynn was duly launched in September at Caversham and almost immediately voyaged to Henley for the Show. After a frantic day or so arranging furniture and stowing Sue's shoe and ballgown collection she was fit to be seen by the public. We fielded many questions about our choice of a 55L but the main interest seemed to focus on Piper's clever reorganisation of the forward cabin which resulted in an extra metre of length in the saloon. We are very pleased with the increased spaciousness.

With a launch so late in the season and getting ourselves sorted, other than travelling to our home marina, there remained limited opportunities for cruising in 2022. However, we eagerly anticipate revisiting our favourite moorings on the Thames as soon as we can in 2023. What was of particular note in our limited cruising experience so far was conning the vessel from the upper deck. This was a special joy for viewing the passing scenery, but you have to guard against unwarranted feelings of superiority as you pass paddleboarders so far below!

Over the winter the boat has proved to be snug, comfortable and warm. All in all we are very pleased with Eawynn and our thanks go to all at Piper Boats who were at all times kind and patient with us. Special thanks are due to Tom for the time he spent guiding our decisions during the design and build processes.

## Happy voyages!

Pat and Sue Willan



# OWNER'S ARTICLE: AREO

The sea has long been part of my balance, along the French coasts or to cross the Atlantic. And I always imagined myself arriving at retirement on board a boat.

At that time, it was a dashing 40-foot sailboat that came to mind.

But this project has never been solitary; it only makes sense if shared. Shared with Elisabeth, adventurer, explorer, nature lover, always wanting to see a little further, wanting to discover. With less list and fewer waves and if we could stop more often to discover the surroundings, it would be good...

So, when the time to prepare for our future life as retirees arrived, we had to ask ourselves the right questions:

Are we staying in the Paris region, and if not, where are we going to settle?

What do we want to do with our days, and above all, what do we want to share?

The answers came easier than expected:

Not, in the Paris region, but we want to take the time to discover before landing.

What do we share? The pleasure of discovery, on foot, by bike, by boat ... and often along the water.

During our bike rides along the canals, we discovered pleasure barges. The real ones, not the huge ones, which are moored all year round along the river in the same place. No, these barges that move forward and allow you to discover our beautiful waterways, but also, everything that revolves around them.

## Yes, that's it!

Small enough to go everywhere, big enough to live all year round comfortably and invite friends and small children. Reliable, manoeuvrable for two, beautiful and equipped with all the modern comforts and, above all, which will last for many years and more.

Sacred specifications, is there a barge that corresponds to it?







In short, you need a boat, an apartment with all modern comforts and a garage for the motorbike (it's better to discover the surroundings).

But we can't find anything, the second-hand market exists, but the barges do not meet our needs. Fortunately, Google, one fine day, led us to the Piper Boats LTD site. Would perfidious Albion be a paradise for freshwater sailors?

Check out Piper's site for all the questions that happy future owners share. Should we opt for a 49, 55, 57, 60 or even 65? An M or luxury model with its rear cabinet. The engine, bigger? The most powerful alternator? The layout of the cabins, the colour, the curtains, how many here, how many there? So many questions...

But at Piper, they know how to listen to you, even when your English teacher was a Spanish cow. (No stress, there is also the essential Yvan who speaks all languages and, above all, who knows the Pipers perfectly, having lived for many years on his own). And above all, they accompany you to create yours on a 3D

plan and then in their workshops. No two Pipers are the same, they are all made based on those long talks with Yvan, Joe, Simon and many others, but most notably, in the end, they look like their owners.

Together, we went through some pitfalls. Covid, Brexit and the first extra community import are unimportant because today Areo is here.

A first-year rich in discoveries, new experiences, meetings and sharing with the Pipers family present along the Burgundy Canal, in Auxerre, on the Nivernais.

Soon, Areo will reach its new home port in the Paris region and prepare there for the Grand Départ of future retirees.

Thank you to the entire Piper Boats Ltd team; without them we would still be at the dream stage, whereas today we are sailing, not on a barge, but on a PIPER.



# HENLEY

## 2023

Each year, Piper Boats organizes an exhibition in Henley-on-Thames, England. The event is similar to what we do here in St Jean De Losne: a gathering for all Piper Boats customers, old and new.

The event represents a great opportunity to discover the barges built by Piper Boats and to chat with their owners.

From all the team at Piper Boats, we look forward to seeing you at Henley.

Register online at  
[www.piperboats.com/henley](http://www.piperboats.com/henley)



PIPER BOATS  
HENLEY-ON-THAMES  
16 & 17 SEPTEMBER 2023



YOU ARE INVITED TO  
THE ANNUAL EVENT OF  
PIPER BOATS AT HENLEY

Discover Piper's "Dutch barge" style boats on the water, chat with their owners, share their experiences and meet the Piper Boats team. We will be a stone's throw from the pretty little town of Henley, at Temple Island Meadow along the River Thames in beautiful Oxfordshire countryside.

To register for this event and make an appointment, please register online at [www.piperboats.com/henley](http://www.piperboats.com/henley) or email [sales@piperboats.com](mailto:sales@piperboats.com) or call 00 44 (0) 1782 510 610

*Date : 16th & 17th September 2023*

*Hours: 10am to 4pm*

*Temple Island Meadows*

*Henley-on-Thames*

*Oxfordshire, United Kingdom*

*RG9 3DB*











Piper Boats Limited, 6 Prospect Way, Victoria Business Park, Biddulph, Stoke-on-Trent, ST8 7PL  
t: +44 (0) 1782 510 610 e: [sales@piperboats.com](mailto:sales@piperboats.com) [www.piperboats.com](http://www.piperboats.com)